



Model RV

Type B Gas Vent



CozyCabin.com 518-623-4349



Typical Installations 3

Technical Data Sheet 4

Vent Pipe..... 5-7

Elbows, Tees and Wyes 7-9

Tops, Supports and Firestops 10-12

Flashings and Storm Collars 13-14

Termination Kit..... 14

Adapters, Connectors and Increasers 14-18

Oval Vent Pipe..... 18-19

Oval Elbows and Tees 19

Oval Tops, Supports and Firestops 19-20

Flashings and Storm Collar..... 21

Oval Adapters, Connectors and Increasers..... 22

DWC Double Wall Flexible Gas Vent Pipe 23

Gas Appliance Chimney Liner Systems 24-26

Submittal Specifications (USA ONLY)..... 26

Typical Installations

DWC DOUBLE WALL FLEXIBLE GAS VENT PIPE

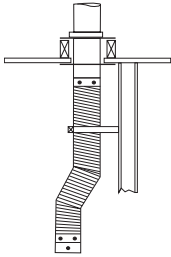

OFFSET THRU CEILING

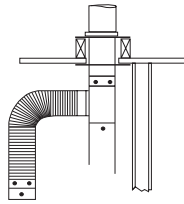

90° OFFSET W/TEE

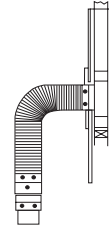

THRU THE WALL

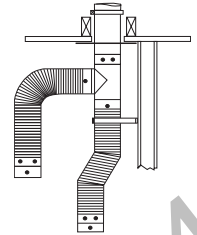

COMBINED VENT
THRU CEILING

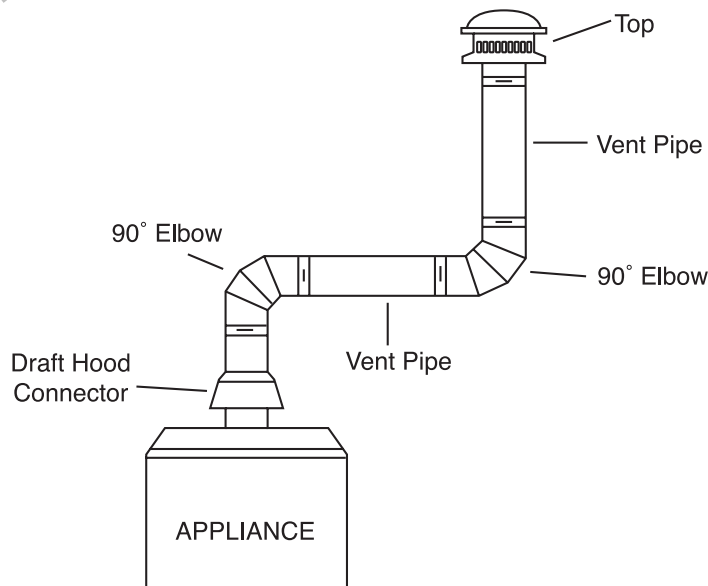
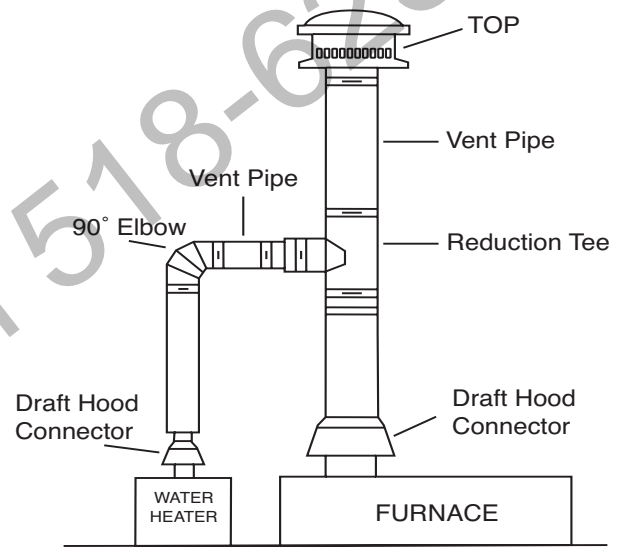
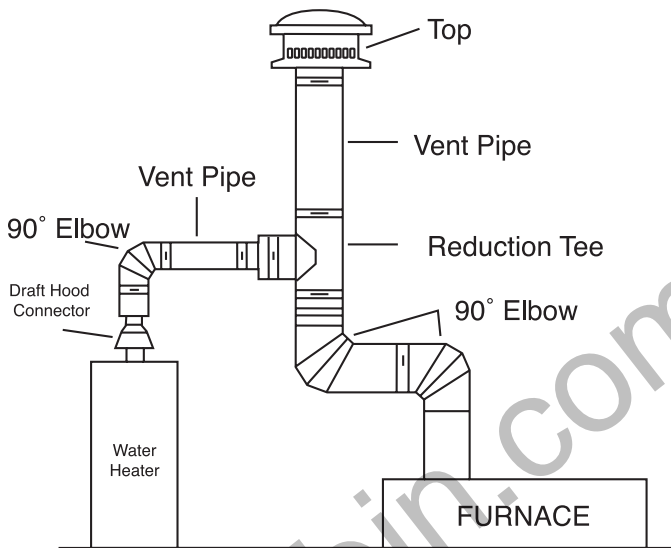

TABLE OF CONTENTS



RV

Round Vent Pipe 3" through 8".....5-18

Selkirk RV round vent pipe is a Listed Type B gas vent pipe. Lengths available range from 6" to 5'. Its adjustable fittings and standard short lengths eliminate all cutting, fitting and special engineering. An improved joint design provides for a rapid and secure connection in seconds. The use of our "LockTab" feature gives installers the option of engaging this tab instead of using sheet metal screws.



OVAL

Oval Vent Pipe 4", 5" and 6".....18-22

Selkirk oval vent pipe, sizes 4", 5" and 6" provides the venting capacity of 4", 5" and 6" round vent pipe. 4" is Listed for both Type B, and Type BW, use/installation in a 2 x 4 wall. 5" is Listed for Type B use/installation in a 2 x 4 and 2 x 6 wall. 6" is Listed for Type B use/installation in a 2 x 6 wall.



DWC/EFC

Double Wall/Expandable Flexible Connectors.....23

Selkirk EFC Expandable Flexible Gas Vent Connector is available in 3" and 4" diameters in 1'-3' and 2'-5' lengths. Selkirk DWC Double Wall Flexible Gas Vent Connector is available in 3", 4", & 5" diameters in 2', 3', 4', & 5' lengths designed for easy connection to standard Type B Gas Vent. DWC is now Listed for use as a "segment" of an unenclosed Type B gas vent system and has full safety certification for use in conditioned and/or unconditioned attics and crawl spaces (USA only). DWC can simplify alignment of most installations by enabling a quick and easy offset between sections of rigid gas vent.



FLEXI-LINER

Aluminum Flexible Chimney Liner For Gas Appliances.....24-26

Available in 25' and 35' lengths, 3" to 8" diameters - 15' kits also available in 3", 4" and 5" diameters. Flexi-Liner kits include Flexi-Liner, Round Top (RV), Flashing with 3" collar and Mortar Guard.

Rugged Construction

Strong, durable galvanized steel outer pipe has internal spacing beads to assure a uniform insulating air space between pipe walls. Each end is die formed to assure uniform sizing for strong, easy to connect joints which resist wasteful handling and shipping damage. In Canada, some lengths are available in galvalume steel outer pipe. The inner aluminum pipe is attached to the outer pipe at only one end. This arrangement allows for differential expansion between the two pipes, eliminating operational noises.

Assured Safety

The double wall (pipe within a pipe) construction with its built-in air space, provides permanent insulation and keeps the inner pipe hot and the outer pipe relatively cool. Such construction creates quick, strong vent action and eliminates condensation in the pipe or overheating of nearby enclosure surfaces.

With special factory supplied parts, 4" OV oval pipe can be installed at less than one inch clearance to combustible surfaces as a Type BW vent for recessed wall furnaces or as a Type B vent through 2 x 4 walls. Check with local authorities if Type BW vent is permissible in your area.

Fully Tested And Listed

Selkirk Gas Vent pipe and fittings have been tested and listed per UL 441 for installation as Type B and BW gas vents to be installed in single and multi-story buildings in accordance with the standards of The National Fire Protection Association NFPA54 and NFPA211. In Canada, Selkirk Gas Vent pipe and fittings have been tested and listed per CAN/ULC-S605 for installation as Type B and BW gas vents and to be installed in single and multi-story buildings in accordance with the Installation Code CSA B-149.

They must be enclosed in occupied portions of a building. When the enclosure is made of combustible material, sizes 3"- 8" diameter pipe must have 1" clearance. Refer to Selkirk illustrated installation instructions for proper procedures.

Warning

The products in this catalog are only for use on listed natural gas or liquid propane Category 1 appliances. Do not use any gas vent on oil or woodburning appliances. These fuels can produce temperatures which may damage the gas vent with resulting hazard to both life and property. These gas vents are not suitable for use when sealed, pressure type, or leakproof systems are called for. For residential "high efficiency" gas burning appliances, which may need sealed systems, Type B vents may be used only if allowed by the appliance manufacturer's installation instructions.

SPECIFICATIONS FOR VENTING APPROVED GAS BURNING APPLIANCES WITH TYPE B GAS VENT PIPE

The gas vent system shall be so engineered and constructed as to develop a positive flow adequate to exhaust all flue gases to outside atmosphere, without condensation within the vent or spillage at any appliance draft hood.

Selkirk gas vent piping shall be installed in full compliance with the terms of its Underwriters' Laboratories, Inc. Listing, with the manufacturer's installation instructions, and with nationally recognized codes representing good practice for such installations.

All flue-gas carrying parts of the vent system shall be Selkirk Type B double-wall gas vent piping, and such piping shall be continuous from the appliances' outlets into the Selkirk vent top of housing.

LOCKTAB® Type "B" Gas Vent



To use the LockTab® feature:

Our non-positional lock system on the Selkirk® RV Gas Vent is the best lock system on the market today. The incorporation of the LockTab® feature simply improves our lock system by adding flexibility and meeting market needs.

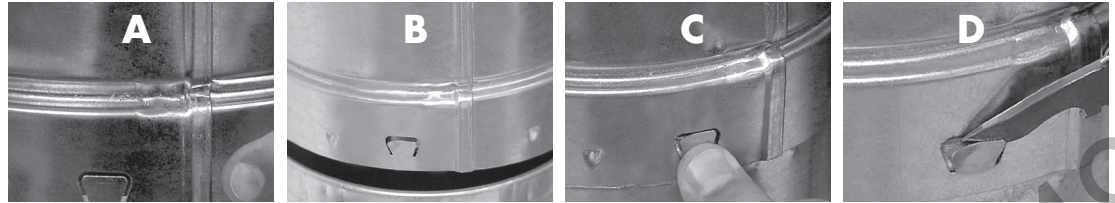

RV 3" through 8"

The RV line of Selkirk round vent pipe and fittings is designed for use on approved gas appliances in residential and light commercial and industrial applications. Round vents for large appliances will be found in the separate catalog for Model R.

NOTE: Size refers to the inside diameter of the pipe or fitting. The outside diameter of RV is approximately 1/2" larger. Outer material is 28 GA galvanized steel. Inner liner is aluminum. In Canada some lengths and fittings are available in galvalume steel.

LOCKTAB: You no longer have to use sheet metal screws to secure pipe connections if required by local code. Just press the "LockTab" and you are done.

Vent Pipe

- Available in 6 diameters.
- Easy to assemble and can be combined to obtain the required installation height
- Sectional overlap of 1.5". Hence, net assembled length is 1.5" less than listed lengths

ROUND PIPE

| Size | Product No. | Part No. | Lengths |
|-------|-------------|----------|-----------------|
| 3" | 103006 | 3RV-6 | Pipe-6" |
| 3" | 103007 | 3RV-6C | Pipe-6" Azm150 |
| 3" | 103012 | 3RV-12 | Pipe-12" |
| 3" | 103013 | 3RV-12C | Pipe-12" Azm150 |
| 3" | 103018 | 3RV-18 | Pipe-18" |
| 3" | 103019 | 3RV-18C | Pipe-18" Azm150 |
| 3" | 103024 | 3RV-24 | Pipe-2' |
| 3" | 103036 | 3RV-36 | Pipe-3' |
| 3" | 103037 | 3RV-36C | Pipe-3' Azm150 |
| 3" | 103048 | 3RV-48 | Pipe-4' |
| 3" | 103060 | 3RV-60 | Pipe-5' |
| 3" | 103061 | 3RV-60C | Pipe-5' Azm150 |
| <hr/> | | | |
| 4" | 104006 | 4RV-6 | Pipe-6" |
| 4" | 104007 | 4RV-6C | Pipe-6" Azm150 |
| 4" | 104012 | 4RV-12 | Pipe-12" |
| 4" | 104013 | 4RV-12C | Pipe-12" Azm150 |
| 4" | 104018 | 4RV-18 | Pipe-18" |
| 4" | 104019 | 4RV-18C | Pipe-18" Azm150 |
| 4" | 104024 | 4RV-24 | Pipe-2' |
| 4" | 104025 | 4RV-24C | Pipe-24" Azm150 |
| 4" | 104036 | 4RV-36 | Pipe-3' |
| 4" | 104037 | 4RV-36C | Pipe-3' Azm150 |

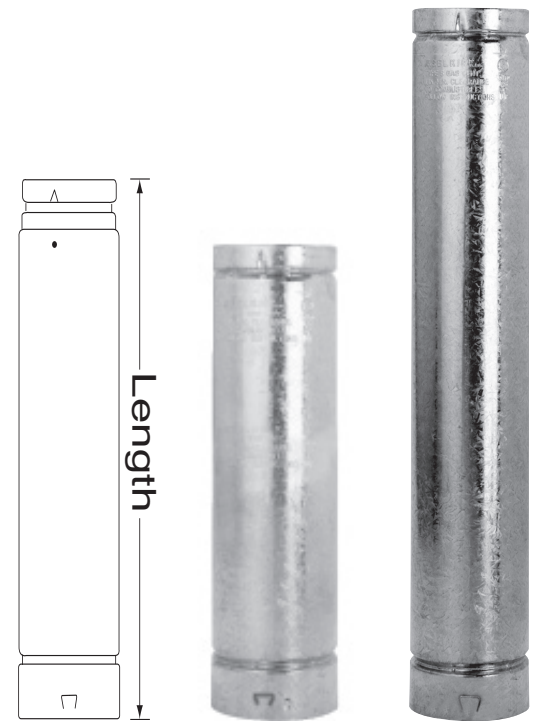

NOTE: For installation in Canada order "Azm 150" only.

ROUND PIPE continued

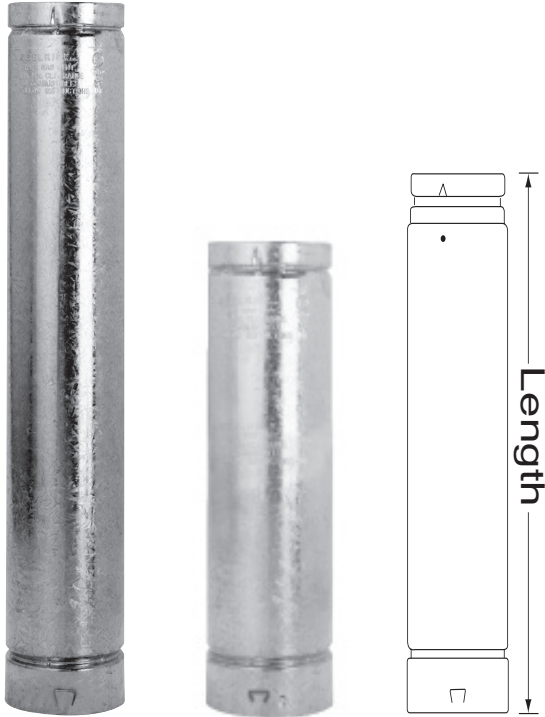

NOTE: For installation in Canada order "Azm 150" only.

| Size | Product No. | Part No. | Lengths |
|------|-------------|----------|-----------------|
| 4" | 104048 | 4RV-48 | Pipe-4' |
| 4" | 104060 | 4RV-60 | Pipe-5' |
| 4" | 104061 | 4RV-60C | Pipe-5' Azm150 |
| 5" | 105006 | 5RV-6 | Pipe-6" |
| 5" | 105007 | 5RV-6C | Pipe-6" Azm150 |
| 5" | 105012 | 5RV-12 | Pipe-12" |
| 5" | 105013 | 5RV-12C | Pipe-12" Azm150 |
| 5" | 105018 | 5RV-18 | Pipe-18" |
| 5" | 105019 | 5RV-18C | Pipe-18" Azm150 |
| 5" | 105024 | 5RV-24 | Pipe-2' |
| 5" | 105025 | 5RV-24C | Pipe-24" Azm150 |
| 5" | 105036 | 5RV-36 | Pipe-3' |
| 5" | 105037 | 5RV-36C | Pipe-3' Azm150 |
| 5" | 105048 | 5RV-48 | Pipe-4' |
| 5" | 105060 | 5RV-60 | Pipe-5' |
| 5" | 105061 | 5RV-60C | Pipe-5' Azm150 |
| 6" | 106006 | 6RV-6 | Pipe-6" |
| 6" | 106007 | 6RV-6C | Pipe-6" Azm150 |
| 6" | 106012 | 6RV-12 | Pipe-12" |
| 6" | 106013 | 6RV-12C | Pipe-12" Azm150 |
| 6" | 106018 | 6RV-18 | Pipe-18" |
| 6" | 106019 | 6RV-18C | Pipe-18" Azm150 |
| 6" | 106024 | 6RV-24 | Pipe-2' |
| 6" | 106025 | 6RV-24C | Pipe-24" Azm150 |
| 6" | 106036 | 6RV-36 | Pipe-3' |
| 6" | 106037 | 6RV-36C | Pipe-3' Azm150 |
| 6" | 106048 | 6RV-48 | Pipe-4' |
| 6" | 106060 | 6RV-60 | Pipe-5' |
| 6" | 106061 | 6RV-60C | Pipe-5' Azm150 |
| 7" | 107006 | 7RV-6 | Pipe-6" |
| 7" | 107012 | 7RV-12 | Pipe-12" |
| 7" | 107013 | 7RV-12C | Pipe-12" Azm150 |
| 7" | 107018 | 7RV-18 | Pipe-18" |
| 7" | 107019 | 7RV-18C | Pipe-18" Azm150 |
| 7" | 107024 | 7RV-24 | Pipe-2' |
| 7" | 107025 | 7RV-24C | Pipe-24" Azm150 |
| 7" | 107036 | 7RV-36 | Pipe-3' |
| 7" | 107037 | 7RV-36C | Pipe-3' Azm150 |
| 7" | 107048 | 7RV-48 | Pipe-4' |
| 7" | 107060 | 7RV-60 | Pipe-5' |
| 7" | 107061 | 7RV-60C | Pipe-5' Azm150 |
| 8" | 108006 | 8RV-6 | Pipe-6" |
| 8" | 108012 | 8RV-12 | Pipe-12" |
| 8" | 108018 | 8RV-18 | Pipe-18" |
| 8" | 108019 | 8RV-18C | Pipe-18" Azm150 |
| 8" | 108024 | 8RV-24 | Pipe-2' |
| 8" | 108036 | 8RV-36 | Pipe-3' |
| 8" | 108037 | 8RV-36C | Pipe-3' Azm150 |
| 8" | 108048 | 8RV-48 | Pipe-4' |
| 8" | 108060 | 8RV-60 | Pipe-5' |
| 8" | 108061 | 8RV-60C | Pipe-5' Azm150 |

Vent Pipe continued

- Used in combination with a straight length, this component assures that an exact required vent length can be achieved
- Allows for easy disassembly and can absorb the linear expansion of longer pipe lengths.
- 12" Length adjusts from 3 1/2" to 10 1/2"
- 18" Length adjusts from 6" to 16"

| Size | Product No. | Part No. | Lengths |
|------|-------------|-----------|---------------|
| 3" | 103082 | 3RV-AJ12 | 12" |
| 3" | 103083 | 3RV-AJ12C | 12" - Azm 150 |
| 3" | 103084 | 3RV-AJ18 | 18" |
| 3" | 103089 | 3RV-AJ18C | 18" - Azm 150 |
| 4" | 104082 | 4RV-AJ12 | 12" |
| 4" | 104084 | 4RV-AJ18 | 18" |
| 4" | 104089 | 4RV-AJ18C | 18" - Azm 150 |
| 5" | 105082 | 5RV-AJ12 | 12" |
| 5" | 105084 | 5RV-AJ18 | 18" |
| 5" | 105089 | 5RV-AJ18C | 18" - Azm 150 |
| 6" | 106082 | 6RV-AJ12 | 12" |
| 6" | 106083 | 6RV-AJ12C | 12" - Azm 150 |
| 6" | 106084 | 6RV-AJ18 | 18" |
| 6" | 106089 | 6RV-AJ18C | 18" - Azm 150 |
| 7" | 107082 | 7RV-AJ12 | 12" |
| 7" | 107083 | 7RV-AJ12C | 12" - Azm 150 |
| 8" | 108082 | 8RV-AJ12 | 12" |
| 8" | 108083 | 8RV-AJ12C | 12" - Azm 150 |

ADJUSTABLE LENGTH



NOTE: For installation in Canada order "Azm 150" only.

Elbows, Tees and Wyes

- Used when an offset is required to avoid obstructions such as rafters, joists and other construction obstacles
- Used to orient pipe between vertical and horizontal orientation
- Four piece adjustable elbow twists for easy offsets

| Size | Product No. | Part No. | A | B |
|------|-------------|------------------|--------|----------|
| 3" | 103230 | 3RV-90 | 6-3/8" | 4-11/16" |
| 3" | 103235 | 3RV-90 - Azm 150 | 6-3/8" | 4-11/16" |
| 4" | 104230 | 4RV-90 | 6-3/8" | 4-11/16" |
| 4" | 104235 | 4RV-90 - Azm 150 | 6-3/8" | 4-11/16" |
| 5" | 105230 | 5RV-90 | 6-3/8" | 4-11/16" |
| 5" | 105235 | 5RV-90 - Azm 150 | 6-3/8" | 4-11/16" |
| 6" | 106230 | 6RV-90 | 6-3/8" | 4-11/16" |
| 6" | 106235 | 6RV-90 - Azm 150 | 6-3/8" | 4-11/16" |
| 7" | 107230 | 7RV-90 | 8" | 6-1/2" |
| 7" | 107235 | 7RV-90 - Azm 150 | 8" | 6-1/2" |
| 8" | 108230 | 8RV-90 | 8-1/4" | 6-3/4" |
| 8" | 108235 | 8RV-90 - Azm 150 | 8-1/4" | 6-3/4" |

90° ADJUSTABLE ELBOW

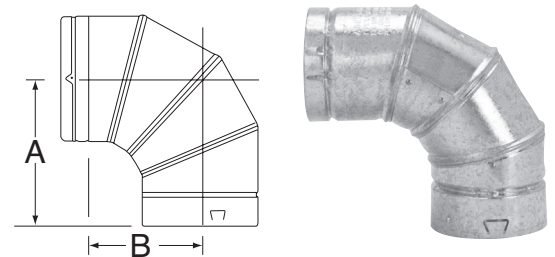

NOTE: For installation in Canada order "Azm 150" only.

45° / 60° ADJUSTABLE ELBOW

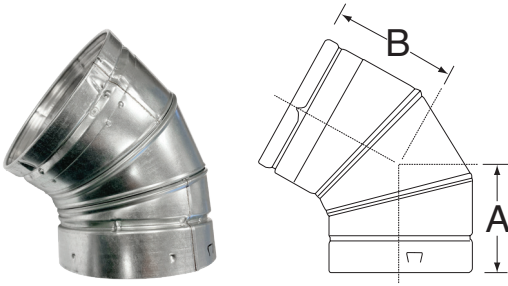

NOTE: For installation in Canada order "Azm 150" only.

- Used when an offset is required to avoid obstructions such as rafters, joists and other construction obstacles.
- Three piece adjustable elbow twists for easy offsets.

| Size | Product No. | Part No. | Outer | A | B |
|------|-------------|------------------|--------|--------|-----------|
| 3" | 103222 | 3RV-EL45/60 | 3-1/2" | 4-3/8" | 4-1 1/16" |
| 3" | 103223 | 3RV-45 - Azm 150 | | 4-3/8" | 4-1 1/16" |
| 4" | 104222 | 4RV-EL45/60 | 4-1/2" | 4-3/8" | 4-1 1/16" |
| 4" | 104223 | 4RV-45 - Azm 150 | | 4-3/8" | 4-1 1/16" |
| 5" | 105222 | 5RV-EL45/60 | 5-1/2" | 4-3/8" | 4-1 1/16" |
| 5" | 105223 | 5RV-45 - Azm 150 | | 4-3/8" | 4-1 1/16" |
| 6" | 106222 | 6RV-EL45/60 | 6-1/2" | 4-3/8" | 4-1 1/16" |
| 6" | 106223 | 6RV-45 - Azm 150 | | 4-3/8" | 4-1 1/16" |

45° ADJUSTABLE ELBOW

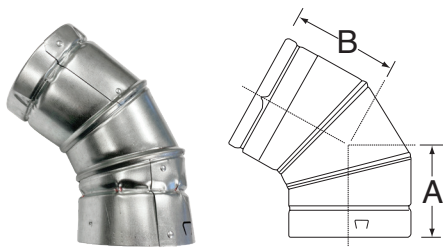

NOTE: For installation in Canada order "Azm 150" only.

| Size | Product No. | Part No. | Outer | A | B |
|------|-------------|------------------|--------|---------|--------|
| 7" | 107215 | 7RV-EL45 | 7-1/2" | 3-3/16" | 7-1/2" |
| 7" | 107220 | 7RV-45 - Azm 150 | 7-1/2" | 3-3/16" | 7-1/2" |
| 8" | 108215 | 8RV-EL45 | 8-1/2" | 3-1/4" | 8-1/2" |
| 8" | 108220 | 8RV-45 - Azm 150 | 8-1/2" | 3-1/4" | 8-1/2" |

STANDARD TEE

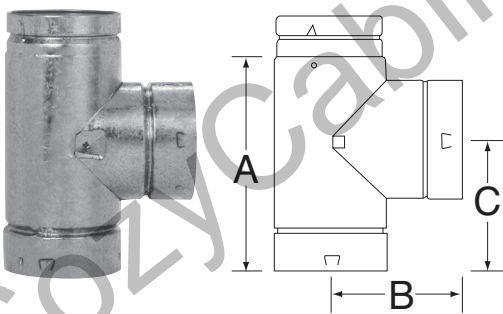

NOTE: For installation in Canada order "Azm 150" only.

- Used to transition system from horizontal to vertical orientation.
- Provides easy access for inspection and maintenance.
- Tee Cap sold separately.

| Size | Product No. | Part No. | A | B | C |
|------|-------------|------------------|---------|--------|--------|
| 3" | 103100 | 3RV-TS | 6-5/8" | 4-1/4" | 4-1/4" |
| 3" | 103101 | 3RV-TS - Azm 150 | 6-5/8" | 4-1/4" | 4-1/4" |
| 4" | 104100 | 4RV-TS | 8-1/2" | 4-3/4" | 5" |
| 4" | 104101 | 4RV-TS - Azm 150 | 8-1/2" | 4-3/4" | 5" |
| 5" | 105100 | 5RV-TS | 9-1/2" | 5-1/4" | 5-1/2" |
| 5" | 105101 | 5RV-TS - Azm 150 | 9-1/2" | 5-1/4" | 5-1/2" |
| 6" | 106100 | 6RV-TS | 10-1/2" | 5-3/4" | 6" |
| 6" | 106101 | 6RV-TS - Azm 150 | 10-1/2" | 5-3/4" | 6" |
| 7" | 107100 | 7RV-TS | 11-1/2" | 6-1/4" | 6-1/2" |
| 7" | 107101 | 7RV-TS - Azm 150 | 11-1/2" | 6-1/4" | 6-1/2" |
| 8" | 108100 | 8RV-TS | 12-1/2" | 6-3/4" | 7" |
| 8" | 108101 | 8RV-TS - Azm 150 | 12-1/2" | 6-3/4" | 7" |

Elbows, Tees and Wyes continued

- Used to transition system from horizontal to vertical orientation.
- Allows small diameter pipe to be connected to the body of the tee.
- Allows connections from 2 or more appliances into the common vent.

| Size | Product No. | Part No. | A | B |
|----------|-------------|----------|---------|--------|
| 4" to 3" | 104103 | 4RV-T3 | 8-1/2" | 4-3/4" |
| 5" to 3" | 105103 | 5RV-T3 | 9-1/2" | 5-1/4" |
| 5" to 4" | 105104 | 5RV-T4 | 9-1/2" | 5-1/4" |
| 6" to 3" | 106103 | 6RV-T3 | 10-1/2" | 5-3/4" |
| 6" to 4" | 106104 | 6RV-T4 | 10-1/2" | 5-3/4" |
| 6" to 5" | 106105 | 6RV-T5 | 10-1/2" | 5-3/4" |
| 7" to 4" | 107104 | 7RV-T4 | 11-1/2" | 6-1/4" |
| 7" to 5" | 107105 | 7RV-T5 | 11-1/2" | 6-1/4" |
| 7" to 6" | 107106 | 7RV-T6 | 11-1/2" | 6-1/4" |
| 8" to 4" | 108104 | 8RV-T4 | 12-1/2" | 6-3/4" |
| 8" to 6" | 108106 | 8RV-T6 | 12-1/2" | 6-3/4" |

REDUCTION TEE

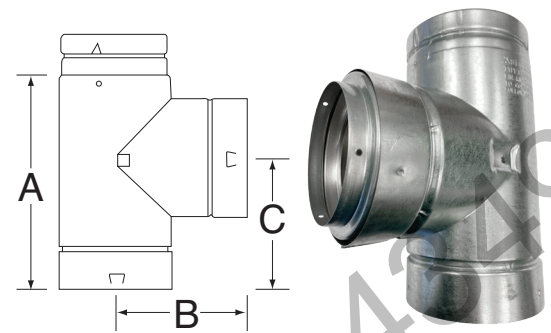

NOTE: Low Profile Double Wall In increaser included.

- Used at bottom of Tee.
- Removable for easy system maintenance.

| Size | Product No. | Part No. |
|------|-------------|----------|
| 3" | 103180 | 3RV-TC |
| 4" | 104180 | 4RV-TC |
| 5" | 105180 | 5RV-TC |
| 6" | 106180 | 6RV-TC |
| 7" | 107180 | 7RV-TC |
| 8" | 108180 | 8RV-TC |

TEE CAP



- Used to transition system from horizontal to vertical orientation.
- Provides better flue gas flow than a traditional Tee.

| Size | Product No. | Part No. | A | B | C | D |
|--------------|-------------|----------|----|----|----|-------|
| 4" x 3" | 104133 | 4RV-3FY | 4" | 4" | 3" | 10" |
| 4" x 4" | 104134 | 4RV-4FY | 4" | 4" | 4" | 10" |
| 5" x 3" | 105133 | 5RV-3FY | 5" | 5" | 3" | 10" |
| 5" x 4" | 105134 | 5RV-4FY | 5" | 5" | 4" | 10" |
| 5" x 4" x 3" | 1051343 | 5RV4-3FY | 5" | 4" | 3" | 11.5" |
| 5" x 4" x 4" | 1051344 | 5RV4-4FY | 5" | 4" | 4" | 11.5" |
| 6" x 3" | 106133 | 6RV-3FY | 6" | 6" | 3" | 11" |
| 6" x 4" | 106134 | 6RV-4FY | 6" | 6" | 4" | 11" |
| 6" x 5" | 106135 | 6RV-5FY | 6" | 6" | 5" | 11" |

FIXED WYE

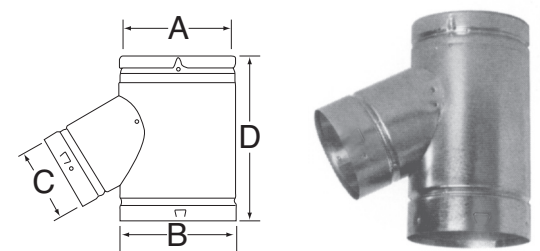

Tops, Supports And Firestops

TOP (BIRD PROOF)

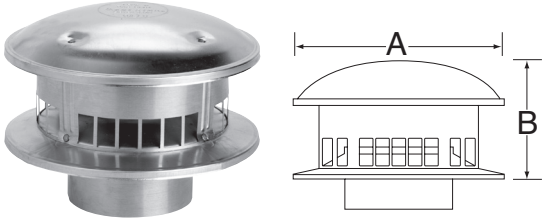

- These tops cannot be used for wood burning applications
- Helps prevent rain and debris from entering the vent.
- External screen prevents entry of most bird species.

| Size | Product No. | Part No. | A | B |
|------|-------------|-----------------|-----|--------|
| 3" | 103800 | 3RV-RT | 6" | 3-1/4" |
| 3" | 103801 | 3RV-RT - Canada | 6" | 3-1/2" |
| 4" | 104800 | 4RV-RT | 8" | 4-1/4" |
| 4" | 104801 | 4RV-RT - Canada | 8" | 4-1/4" |
| 5" | 105800 | 5RV-RT | 10" | 5-1/4" |
| 5" | 105801 | 5RV-RT - Canada | 10" | 5-1/4" |
| 6" | 106800 | 6RV-RT | 12" | 6-1/4" |
| 6" | 106801 | 6RV-RT - Canada | 12" | 6-1/4" |
| 7" | 107800 | 7RV-RT | 14" | 7-1/2" |
| 7" | 107801 | 7RV-RT - Canada | 14" | 7-1/2" |
| 8" | 108800 | 8RV-RT | 16" | 8-1/2" |
| 8" | 108801 | 8RV-RT - Canada | 16" | 8-1/2" |

HI-WIND TOP

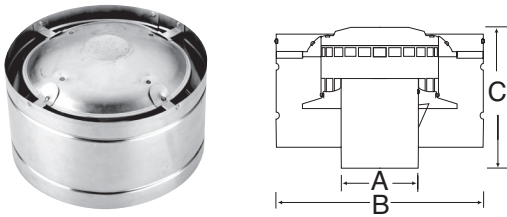

- Used in high wind environments.
- Improves flue gas flow to prevent downdrafts.

| Size | Product No. | Part No. | A | B | C |
|------|-------------|------------------|----|-----|--------|
| 3" | 103802 | 3RV-HWT | 3" | 8" | 5-1/2" |
| 3" | 103804 | 3RV-HWT - Canada | 3" | 8" | 5-1/2" |
| 4" | 104802 | 4RV-HWT | 4" | 10" | 6" |
| 4" | 104804 | 4RV-HWT - Canada | 4" | 10" | 6" |
| 5" | 105802 | 5RV-HWT | 5" | 12" | 7" |
| 5" | 105804 | 5RV-HWT - Canada | 5" | 12" | 7" |
| 6" | 106802 | 6RV-HWT | 6" | 14" | 7-1/2" |
| 6" | 106804 | 6RV-HWT - Canada | 6" | 14" | 7-1/2" |

SUPPORT ASSEMBLY

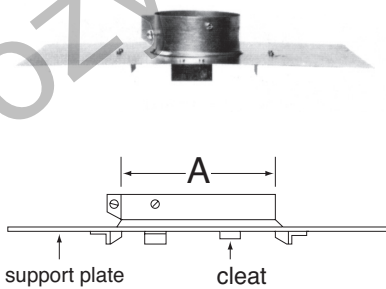

- Support Plate should be installed above the joist.
- Support Plate also serves as a firestop.
- Will support a maximum of 35' of gas vent.

| Size | Product No. | Part No. | A | Plate Dim. |
|------|-------------|------------------|--------|------------|
| 3" | 103400 | 3RV-GVS | 3-5/8" | 17" x 10" |
| 3" | 103401 | 3RV-GVS - Canada | 3-5/8" | 17" x 10" |
| 4" | 104400 | 4RV-GVS | 4-5/8" | 17" x 10" |
| 4" | 104401 | 4RV-GVS - Canada | 4-5/8" | 17" x 10" |
| 5" | 105400 | 5RV-GVS | 5-5/8" | 17" x 12" |
| 5" | 105401 | 5RV-GVS - Canada | 5-5/8" | 17" x 12" |
| 6" | 106400 | 6RV-GVS | 6-5/8" | 17" x 12" |
| 6" | 106401 | 6RV-GVS - Canada | 6-5/8" | 17" x 12" |
| 7" | 107400 | 7RV-GVS | 7-5/8" | 17" x 14" |
| 7" | 107401 | 7RV-GVS - Canada | 7-5/8" | 17" x 14" |
| 8" | 108400 | 8RV-GVS | 8-5/8" | 17" x 14" |
| 8" | 108401 | 8RV-GVS - Canada | 8-5/8" | 17" x 14" |

Tops, Supports And Firestops continued

| Size | Product No. | Part No. | A |
|------|-------------|----------|--------|
| 3" | 103402 | 3RV-GVSB | 3-5/8" |
| 4" | 104402 | 4RV-GVSB | 4-5/8" |
| 5" | 105402 | 5RV-GVSB | 5-5/8" |
| 6" | 106402 | 6RV-GVSB | 6-5/8" |
| 7" | 107402 | 7RV-GVSB | 7-5/8" |

- Used to ensure clearance to combustibles is maintained.
- Wall Thimble also serves as a firestop.
- Adjusts from 4 - 1/8" to 7" to fit thickness of wall.

| Size | Product No. | Part No. | A | B |
|------|-------------|----------|--------|---------|
| 3" | 187703 | 3RV-WT | 3-5/8" | 7" |
| 4" | 187704 | 4RV-WT | 4-5/8" | 8-1/4" |
| 5" | 187705 | 5RV-WT | 5-5/8" | 9-1/2" |
| 6" | 187706 | 6RV-WT | 6-5/8" | 10-3/4" |
| 7" | 187707 | 7RV-WT | 7-5/8" | 11" |
| 8" | 187708 | 8RV-WT | 8-5/8" | 12-1/2" |

- Used to support and stabilize the pipe against a wall.
- Will support up to 35'

| Size | Product No. | Part No. | A |
|------|-------------|----------|--------|
| 3" | 103430 | 3RV-WS/B | 3-5/8" |
| 4" | 104430 | 4RV-WS/B | 4-5/8" |
| 5" | 105430 | 5RV-WS/B | 5-5/8" |
| 6" | 106430 | 6RV-WS/B | 6-5/8" |
| 7" | 107430 | 7RV-WS/B | 7-5/8" |
| 8" | 108430 | 8RV-WS/B | 8-5/8" |

- Used to stabilize the pipe against a wall.
- Must be installed just above the Tee and every 6' thereafter

| Size | Product No. | Part No. | A |
|------|-------------|----------|------------|
| 3" | 103431 | 3RV-WB | 3-1/2" min |
| 4" | 104431 | 4RV-WB | 4-1/2" min |
| 5" | 105431 | 5RV-WB | 5-1/2" min |

GAS VENT SUPPORT COLLAR & HARDWARE

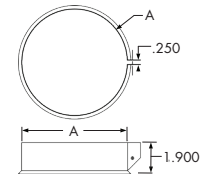

WALL THIMBLE

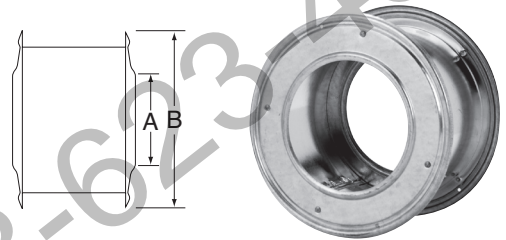

WALL SUPPORT/BAND ASSEMBLY

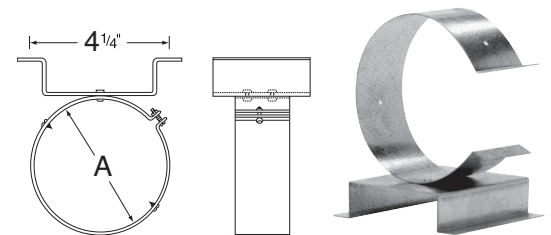

WALL BAND

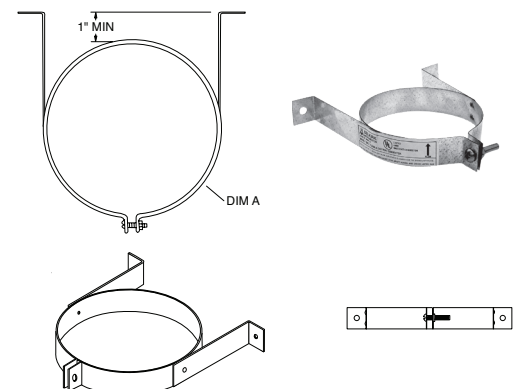

GAS VENT FIRESTOP SPACER

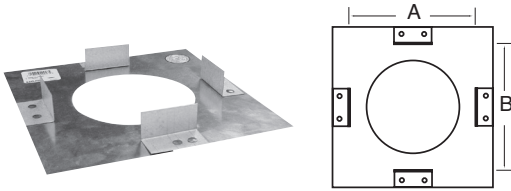

- Used to protect combustible materials where pipe passes through a ceiling or wall
- Extended bottom flange

| Size | Product No. | Part No. | A | B |
|------|-------------|----------|---------|---------|
| 3" | 103461 | 3RV-FS | 5-1/2" | 5-1/2" |
| 4" | 104461 | 4RV-FS | 6-1/2" | 6-1/2" |
| 5" | 105461 | 5RV-FS | 7-1/2" | 7-1/2" |
| 6" | 106461 | 6RV-FS | 8-1/2" | 8-1/2" |
| 7" | 107461 | 7RV-FS | 9-1/2" | 9-1/2" |
| 8" | 108461 | 8RV-FS | 10-1/2" | 10-1/2" |

QUICK GRIP FIRESTOP/SUPPORT

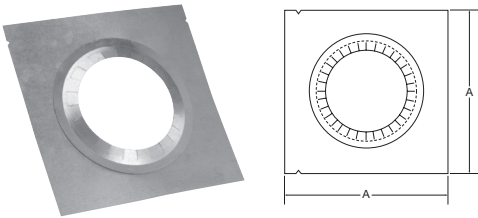

NOTE: In Canada use only UL-listed model.

- Used to support and protect combustible materials where the pipe passes through a ceiling

| Size | Product No. | Part No. | A |
|------|-------------|----------|-----|
| 3" | 103406 | 3RV-FSP | 9" |
| 4" | 104406 | 4RV-FSP | 10" |
| 5" | 105406 | 5RV-FSP | 11" |
| 6" | 106406 | 6RV-FSP | 12" |

QUICK GRIP FIRESTOP/SUPPORT - UL MODEL

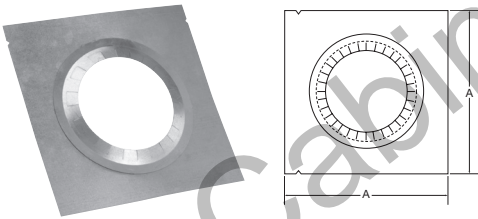

NOTE: UL-listed model includes an attached spacer ring to ensure 1" clearance to combustibles. In Canada use only UL-listed model.

- Used to support and protect combustible materials where the pipe passes through a ceiling

| Size | Product No. | Part No. | A |
|------|-------------|----------|-----|
| 3" | 103404 | 3RV-FSPU | 9" |
| 4" | 104404 | 4RV-FSPU | 10" |
| 5" | 105404 | 5RV-FSPU | 11" |
| 6" | 106404 | 6RV-FSPU | 12" |

PIPE COLLAR

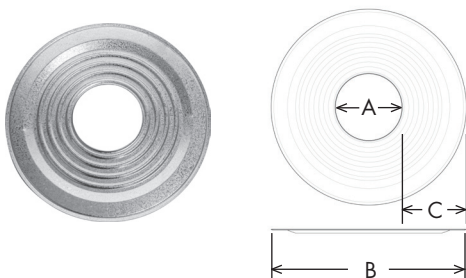

- Provides a decorative/finished appearance.

| Size | Product No. | Part No. | A | B | C |
|------|-------------|----------|--------|-----------|---------|
| 3" | 103460 | 3RV-GC | 3-5/8" | 10-11/16" | 3-9/16" |
| 4" | 104460 | 4RV-GC | 4-5/8" | 10-11/16" | 3-1/16" |
| 5" | 105460 | 5RV-GC | 5-5/8" | 10-11/16" | 2-9/16" |
| 6" | 106460 | 6RV-GC | 6-5/8" | 10-11/16" | 2-1/16" |
| 7" | 107460 | 7RV-GC | 7-5/8" | 11-1/4" | 1-3/4" |

Flashings and Storm Collars

- Used where the vent passes through a roof.

| Size | Product No. | Part No. | A | B | C | D |
|------|-------------|----------|--------|-----------|-----------|----------|
| 3" | 103825 | 3RV-AF | 3-1/2" | 14-7/8" | 12-1/4" | 6-11/16" |
| 4" | 104825 | 4RV-AF | 4-1/2" | 16" | 13-1/4" | 7-3/4" |
| 5" | 105825 | 5RV-AF | 5-1/2" | 16-15/16" | 14-1/4" | 8-7/8" |
| 6" | 106825 | 6RV-AF | 6-1/2" | 18" | 15-1/4" | 10" |
| 7" | 107825 | 7RV-AF | 7-1/2" | 19-1/8" | 16" | 11-1/8" |
| 8" | 108825 | 8RV-AF | 8-1/2" | 20-1/4" | 16-15/16" | 12-1/4" |

ADJUSTABLE ROOF FLASHING - FLAT TO 6/12

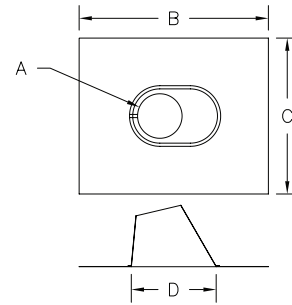

- Used where the vent passes through a roof.

| Size | Product No. | Part No. | A | B | C | D |
|------|-------------|----------|--------|---------|-----------|---------|
| 3" | 103830 | 3RV-AF12 | 3-1/2" | 18" | 15-1/4" | 10-1/4" |
| 4" | 104830 | 4RV-AF12 | 4-1/2" | 19-1/8" | 16" | 11-1/8" |
| 5" | 105830 | 5RV-AF12 | 5-1/2" | 20-1/4" | 16-15/16" | 12-1/4" |
| 6" | 106830 | 6RV-AF12 | 6-1/2" | 24-1/4" | 20" | 15-5/8" |
| 7" | 107830 | 7RV-AF12 | 7-1/2" | 24-1/4" | 20" | 15-5/8" |
| 8" | 108830 | 8RV-AF12 | 8-1/2" | 25" | 19-1/2" | 17-1/8" |

ADJUSTABLE ROOF FLASHING 6/12 TO 12/12

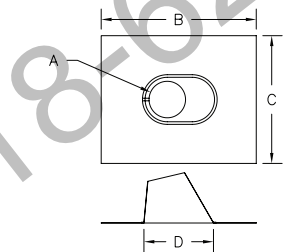

- Used where the vent passes through a roof.
- Adjustable to 6/12 pitch

| Size | Product No. | Part No. | A | B | C |
|------|-------------|----------|--------|----------|---------|
| 3" | 103820 | 3RV-TFA | 8-3/4" | 11" | 19-1/2" |
| 4" | 104820 | 4RV-TFA | 8-3/4" | 11" | 19-1/2" |
| 5" | 105820 | 5RV-TFA | 8-3/4" | 11" | 19-1/2" |
| 6" | 106820 | 6RV-TFA | 8-3/4" | 11" | 19-1/2" |
| 7" | 107820 | 7RV-TFA | 8-3/4" | 14" | 22" |
| 8" | 108820 | 8RV-TFA | 8-1/4" | 15-3/16" | 23" |

TALL CONE ADJUSTABLE ROOF FLASHING

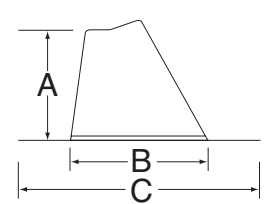

- Used on flat roof surfaces.

| Size | Product No. | Part No. | A | B | C |
|------|-------------|----------|-----|--------|---------|
| 3" | 103815 | 3RV-TF | 12" | 7-1/2" | 16-1/2" |
| 4" | 104815 | 4RV-TF | 12" | 7-1/2" | 16-1/2" |
| 5" | 105815 | 5RV-TF | 12" | 7-1/2" | 16-1/2" |
| 6" | 106815 | 6RV-TF | 12" | 11" | 19-1/2" |
| 7" | 107815 | 7RV-TF | 12" | 11" | 19-1/2" |
| 8" | 108815 | 8RV-TF | 12" | 11" | 19-1/2" |

TALL CONE FLAT ROOF FLASHING

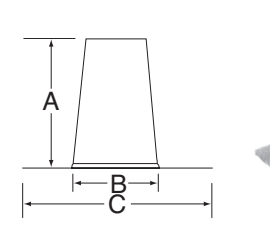

STORM COLLAR

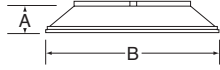

- Used to provide a weather proof seal to pipe above roof line.
- Used above the Flashing.
- Seal inner edge with hi-temp silicone sealant.

| Size | Product No. | Part No. | A | B |
|------|-------------|----------|---------|---------|
| 3" | 103810 | 3RV-SC | 1-9/16" | 6-5/8" |
| 4" | 104810 | 4RV-SC | 1-9/16" | 7-5/8" |
| 5" | 105810 | 5RV-SC | 1-9/16" | 8-5/8" |
| 6" | 106810 | 6RV-SC | 1-9/16" | 9-5/8" |
| 7" | 107810 | 7RV-SC | 1-9/16" | 10-3/4" |
| 8" | 108810 | 8RV-SC | 1-9/16" | 11-3/4" |

NOTE: See instructions for use/limitations

Termination Kit

RV TERMINATION KIT (USA ONLY)



- For terminating vertically in most common installations
- Includes: Round Top, Flashing Flat to 6/12, Storm Collar, and Draft Hood Connector.

| Size | Product No. | Part No. |
|------|-------------|----------|
| 3" | 183600 | 3RV-TK |
| 4" | 184600 | 4RV-TK |
| 5" | 185600 | 5RV-TK |
| 6" | 186600 | 6RV-TK |

* Does not include pipe length.

Adapters, Connectors And Increases

DRAFT HOOD CONNECTOR

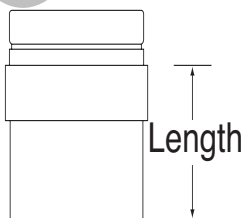

- Connects single wall Vent to B Vent.
- Used to connect pipe to draft hood at appliance.

| Size | Product No. | Part No. | Length |
|------|-------------|------------------|--------|
| 3" | 103240 | 3RV-DH | 4-1/2" |
| 3" | 103241 | 3RV-DH - Azm 150 | 4-1/2" |
| 4" | 104240 | 4RV-DH | 4-1/2" |
| 4" | 104241 | 4RV-DH - Azm 150 | 4-1/2" |
| 5" | 105240 | 5RV-DH | 4-1/2" |
| 5" | 105241 | 5RV-DH - Azm 150 | 4-1/2" |
| 6" | 106240 | 6RV-DH | 4-1/2" |
| 6" | 106241 | 6RV-DH - Azm 150 | 4-1/2" |
| 7" | 107240 | 7RV-DH | 7" |
| 7" | 107241 | 7RV-DH - Azm 150 | 7" |
| 8" | 108240 | 8RV-DH | 8" |
| 8" | 108241 | 8RV-DH - Azm 150 | 8" |

NOTE: For installation in Canada order "Azm 150" only.

Adapters, Connectors And Increases *continued*

- Connects B Vent to C Vent.
- Used to connect pipe to single wall.

| Size | Product No. | Part No. | A | B |
|------|-------------|------------|-------|-------|
| 3" | 103242 | 3RV-REV-DH | 3.51" | 2.95" |
| 4" | 104242 | 4RV-REV-DH | 4.51" | 3.95" |
| 5" | 105242 | 5RV-REV-DH | 5.51" | 4.95" |
| 6" | 106242 | 6RV-REV-DH | 6.51" | 5.95" |
| 7" | 107242 | 7RV-REV-DH | 7.51" | 6.95" |
| 8" | 108242 | 8RV-REV-DH | 8.51" | 7.95" |

REVERSE DRAFT HOOD CONNECTOR

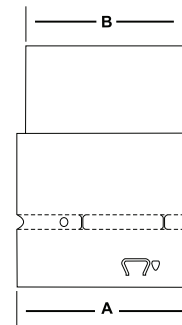

- Connects single wall Vent to B Vent.
- Used to connect pipe to draft hood at appliance.

| Size | Product No. | Part No. | Length |
|------|-------------|----------|--------|
| 4" | 104243 | 4RV-DHCL | 5" |

DRAFT HOOD CONNECTOR LONG (USA ONLY)

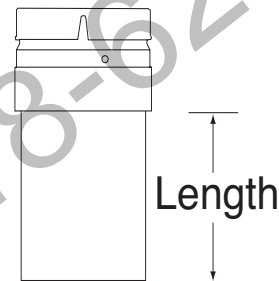

- Used to connect B Vent to/from 1/4" Type B Gas Vent
- Allows Selkirk B Vent to be used in conjunction with other brands of existing vent.

| Size | Product No. | Part No. |
|------|-------------|-------------------|
| 3" | 103079 | 3RV-UAM - Azm 150 |
| 3" | 103081 | 3RV-UAM |
| 4" | 104079 | 4RV-UAM - Azm 150 |
| 4" | 104081 | 4RV-UAM |
| 5" | 105079 | 5RV-UAM - Azm 150 |
| 5" | 105081 | 5RV-UAM |
| 6" | 106079 | 6RV-UAM - Azm 150 |
| 6" | 106081 | 6RV-UAM |
| 7" | 107079 | 7RV-UAM - Azm 150 |
| 7" | 107081 | 7RV-UAM |
| 8" | 108079 | 8RV-UAM - Azm 150 |
| 8" | 108081 | 8RV-UAM |

UNIVERSAL ADAPTER - MALE 1/4"

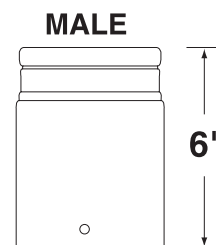

NOTE: Male adapter used to adapt to Selkirk pipe toward termination.

NOTE: For installation in Canada order "Azm 150" only.

UNIVERSAL ADAPTER - FEMALE 1/4"

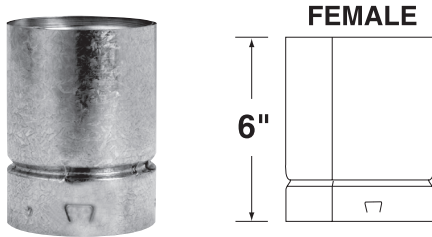

NOTE: Female adapter used to adapt to Selkirk pipe toward appliance.

NOTE: For installation in Canada order "Azm 150" only.

- Used to connect B Vent to/from 1/4" Type B Gas Vent
- Allows Selkirk B Vent to be used in conjunction with other brands of existing vent.

| Size | Product No. | Part No. |
|------|-------------|-------------------|
| 3" | 103078 | 3RV-UAF - Azm 150 |
| 3" | 103080 | 3RV-UAF |
| 4" | 104078 | 4RV-UAF - Azm 150 |
| 4" | 104080 | 4RV-UAF |
| 5" | 105078 | 5RV-UAF - Azm 150 |
| 5" | 105080 | 5RV-UAF |
| 6" | 106078 | 6RV-UAF - Azm 150 |
| 6" | 106080 | 6RV-UAF |
| 7" | 107078 | 7RV-UAF - Azm 150 |
| 7" | 107080 | 7RV-UAF |
| 8" | 108078 | 8RV-UAF - Azm 150 |
| 8" | 108080 | 8RV-UAF |

UNIVERSAL ADAPTER - MALE 1/2"

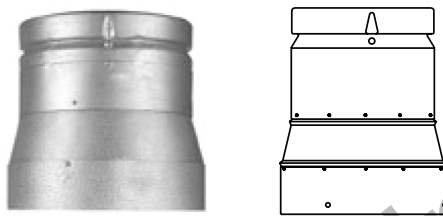

NOTE: Male adapter used to adapt to Selkirk pipe toward termination.

- Used to connect B Vent from 1/2" male to 1/4" female Type B Gas Vent
- Allows Selkirk B Vent to be used in conjunction with other brands of existing vent.

| Size | Product No. | Part No. |
|------|-------------|-----------|
| 4" | 104077 | 4RV-UAM.5 |
| 5" | 105077 | 5RV-UAM.5 |
| 6" | 106077 | 6RV-UAM.5 |

UNIVERSAL ADAPTER - FEMALE 1/2"

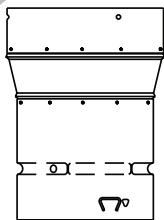

NOTE: Female adapter used to adapt to Selkirk pipe toward the appliance

- Used to connect B Vent from 1/2" female to 1/4" male Type B Gas Vent
- Allows Selkirk B Vent to be used in conjunction with other brands of existing vent.

| Size | Product No. | Part No. |
|------|-------------|-----------|
| 4" | 104076 | 4RV-UAF.5 |
| 5" | 105076 | 5RV-UAF.5 |
| 6" | 106076 | 6RV-UAF.5 |

Adapters, Connectors And Increases continued

- Increase 3" to 4" only.

| Size | Product No. | Part No. |
|---------|-------------|----------|
| 3" x 4" | 103244 | 3RV-AI4 |
| 3" x 4" | 104248* | 4RV-3RA |

- Used to increase pipe diameter.

| Size | Product No. | Part No. |
|---------|-------------|----------|
| 3" x 4" | 103324 | 3RV-I4DW |
| 3" x 5" | 103325 | 3RV-I5DW |
| 4" x 5" | 104325 | 4RV-I5DW |
| 4" x 6" | 104326 | 4RV-I6DW |
| 5" x 6" | 105326 | 5RV-I6DW |

- Used to increase pipe diameter
- Used for tight installations to optimize space.

| Size | Product No. | Part No. |
|----------|-------------|----------|
| 3" x 4" | 103304 | 3RV-I4 |
| 3" x 5" | 103305 | 3RV-I5 |
| 3" x 6" | 103306 | 3RV-I6 |
| 3" x 7" | 103307 | 3RV-I7 |
| 3" x 8" | 103308 | 3RV-I8 |
| 4" x 5" | 104305 | 4RV-I5 |
| 4" x 6" | 104306 | 4RV-I6 |
| 4" x 7" | 104307 | 4RV-I7 |
| 4" x 8" | 104308 | 4RV-I8 |
| 5" x 6" | 105306 | 5RV-I6 |
| 5" x 7" | 105307 | 5RV-I7 |
| 5" x 8" | 105308 | 5RV-I8 |
| 6" x 7" | 106307 | 6RV-I7 |
| 6" x 8" | 106308 | 6RV-I8 |
| 7" x 8" | 107308 | 7RV-I8 |
| 8" x 10" | 108310 | 8RV-I10 |

APPLIANCE INCREASERS (USA ONLY)

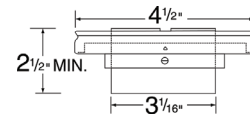

* Only for use with Rheem / Ruud Appliances

DOUBLE WALL INCREASER

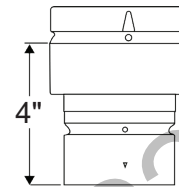

LOW PROFILE DOUBLE WALL INCREASER

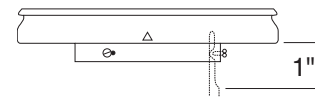

NOTE: Other sizes available for project work on special order.
Allow 30 working days after placing order.
Maximum screw size 3/8".

REDUCER (USA ONLY)

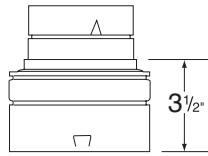

| Size | Product No. | Part No. | 1 Step |
|------|-------------|----------|---------|
| 4" | 104363 | 4RV-R3 | 4" x 3" |
| 5" | 105364 | 5RV-R4 | 5" x 4" |
| 6" | 106365 | 6RV-R5 | 6" x 5" |
| 7" | 107366 | 7RV-R6 | 7" x 6" |
| 8" | 108367 | 8RV-R7 | 8" x 7" |

NOTE: One step only

ATTIC INSULATION SHIELD

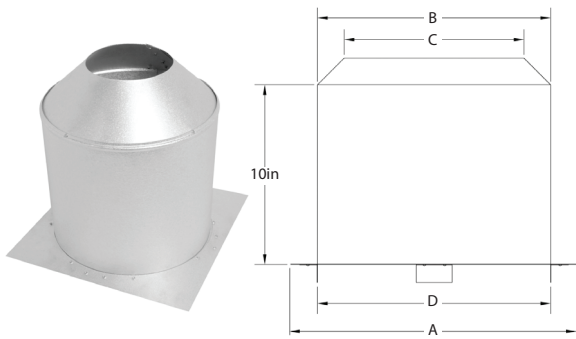

- The AIS must be installed where the pipe enters the attic space in any installation.
- Designed to keep insulation away from the pipe and to maintain the mandatory 1" clearance to combustibles.

| Size | A | B | C | D | Product No. | Pack |
|------|---------|---------|----------|---------|-------------|------|
| 3" | 7-1/2" | 5-1/2" | 3-19/32" | 5-1/2" | 103490 | 1 |
| 4" | 8-1/2" | 6-1/2" | 4-19/32" | 6-1/2" | 104490 | 1 |
| 5" | 9-1/2" | 7-1/2" | 5-19/32" | 7-1/2" | 105490 | 1 |
| 6" | 10-1/2" | 8-1/2" | 6-19/32" | 8-1/2" | 106490 | 1 |
| 7" | 11-1/2" | 9-1/2" | 7-19/32" | 9-1/2" | 107490 | 1 |
| 8" | 12-1/2" | 10-1/2" | 8-19/32" | 10-1/2" | 108490 | 1 |

Oval Vent Pipe

OVAL PIPE - 4", 5", 6" (USA ONLY)

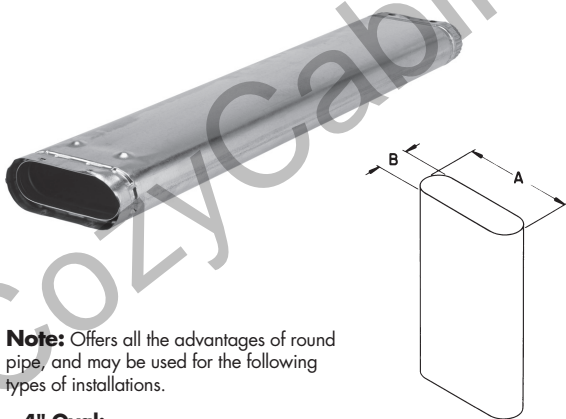

Note: Offers all the advantages of round pipe, and may be used for the following types of installations.

4" Oval:

- Conventional Type B
- Type B-2x4 when used with firestop
- Type BW-2x4 with recessed heater

5" Oval:

- Type B
- Type B-2x4

6" Oval:

- Type B-2x6

| Diameter | Length | A | B | Product No. | Part No. |
|-----------|--------|---------|--------|-------------|----------|
| 4" | 6 | 7-1/16" | 2-7/8" | 164006 | 4OV-06 |
| 4" | 12 | 7-1/16" | 2-7/8" | 164012 | 4OV12 |
| 4" | 18 | 7-1/16" | 2-7/8" | 164018 | 4OV18 |
| 4" | 24 | 7-1/16" | 2-7/8" | 164024 | 4OV24 |
| 4" | 36 | 7-1/16" | 2-7/8" | 164036 | 4OV36 |
| 4" | 48 | 7-1/16" | 2-7/8" | 164048 | 4OV48 |
| 4" | 60 | 7-1/16" | 2-7/8" | 164060 | 4OV60 |
| 5" | | | | | |
| 5" | 6 | 10-3/4" | 2-7/8" | 165006 | 5OV-06 |
| 5" | 12 | 10-3/4" | 2-7/8" | 165012 | 5OV12 |
| 5" | 18 | 10-3/4" | 2-7/8" | 165018 | 5OV18 |
| 5" | 24 | 10-3/4" | 2-7/8" | 165024 | 5OV24 |
| 5" | 36 | 10-3/4" | 2-7/8" | 165036 | 5OV36 |
| 5" | 48 | 10-3/4" | 2-7/8" | 165048 | 5OV48 |
| 5" | 60 | 10-3/4" | 2-7/8" | 165060 | 5OV60 |
| 6" | | | | | |
| 6" | 6 | 11-1/2" | 3-1/4" | 166006 | 6OV-06 |
| 6" | 12 | 11-1/2" | 3-1/4" | 166012 | 6OV12 |
| 6" | 18 | 11-1/2" | 3-1/4" | 166018 | 6OV18 |
| 6" | 24 | 11-1/2" | 3-1/4" | 166024 | 6OV24 |
| 6" | 36 | 11-1/2" | 3-1/4" | 166036 | 6OV36 |

Oval Vent Pipe continued

- The adjustable length overlaps the standard pipe section to permit adjustments from 3" to 10".

| Size | Product No. | Part No. |
|------|-------------|----------|
| 4" | 164082 | 40V-AJ |
| 5" | 165082 | 50V-AJ |
| 6" | 166082 | 60V-AJ |

ADJUSTABLE OVAL PIPE (USA ONLY)



Oval Elbows, Tees And Wyes

- The standard 45° elbow is used in pairs where offsets are desired in 1" minimum clearance enclosures or open spaces, such as attics or basements. Add pipe sections between pairs to produce additional offset.

| Size | Product No. | Part No. | A | B |
|------|-------------|----------|--------|--------|
| 4" | 164215 | 4OV-45S | 3" | 3" |
| 5" | 165215 | 5OV-45S | 3 1/2" | 3 1/2" |
| 6" | 166215 | 6OV-45S | 4" | 4" |

45° OVAL ELBOW (USA ONLY)

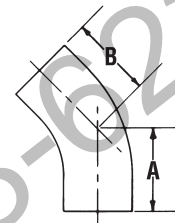

- The flat 45° elbow is used in pairs where offsets are desired in 1" minimum clearance enclosures or open spaces, such as attics or basements. Add pipe sections between pairs to produce additional offset.

| Size | Product No. | Part No. | A | B |
|------|-------------|----------|--------|--------|
| 4" | 164220 | 4OV-45F | 3-3/4" | 3-3/4" |
| 5" | 165220 | 5OV-45F | 4-3/4" | 4-3/4" |
| 6" | 166220 | 6OV-45F | 5" | 5" |

45° OVAL ELBOW - FLAT (USA ONLY)

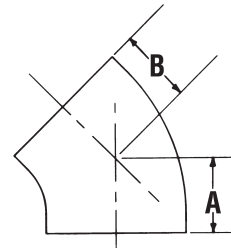

- The branch size and trunk size have the same diameter. The tee branch accepts either double- or single-wall pipe.

| Size | Product No. | Part No. | A | B | C |
|------|-------------|----------|-----|---------|--------|
| 4" | 164100 | 40V-TS | 12" | 2-9/16" | 2-3/8" |
| 5" | 165100 | 50V-TS | 12" | 2-9/16" | 2-3/8" |
| 6" | 166100 | 60V-TS | 12" | 2-5/8" | 2-3/4" |

STANDARD OVAL TEE (USA ONLY)

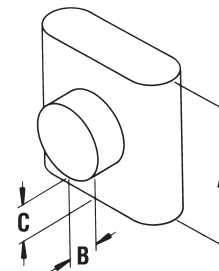

- The tee cap is used for closing off the bottom of the tee.

| Size | Product No. | Part No. |
|------|-------------|----------|
| 4" | 164180 | 40V-TC |
| 5" | 165180 | 50V-TC |
| 6" | 166180 | 60V-TC |

STANDARD OVAL TEE CAP (USA ONLY)



Oval Tops, Supports And Firestops

4" OVAL TOP (USA ONLY)

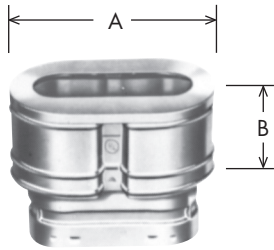

| Size | Product No. | Part No. | A | B |
|------|-------------|----------|-----------------|--------|
| 4" | 164800 | 4OV-OT | 5-3/8" x 8-1/2" | 3-1/2" |

NOTE: For 5OV and 6OV Tops, use Oval to Round Adapters in conjunction with standard RV Round Tops.

OVAL VENT KIT



- The kit includes: 2 - 4OV-24, 4OV-BP, 4OV-CS, 4OV-RV4

| Size | Product No. | Part No. |
|------|-------------|----------|
| 4" | 164620 | 4OV-YK |

OVAL TEE SUPPORT (USA ONLY)



- The tee support is used to support and center the tee. Use with the tee cap shown above

| Size | Product No. | Part No. |
|------|-------------|----------|
| 4" | 164430 | 4OV-ST |
| 5" | 165430 | 5OV-ST |
| 6" | 166430 | 6OV-ST |

OVAL FIRESTOP SPACERS (USA ONLY)



- The firestop spacers center vent in 16" O.C. stud space and serve as a firestop at the ceiling level. This is a required component for Type B 2 x 4 and multi-story Type BW installations.

| Size | Product No. | Part No. | Wall |
|------|-------------|----------|---------|
| 4" | 164460 | 4OV-FS | 2" x 4" |
| 5" | 165460 | 5OV-FS | 2" x 4" |
| 4" | 164465 | 4OV-FS6 | 2" x 6" |
| 5" | 165465 | 5OV-FS6 | 2" x 6" |
| 6" | 166460 | 6OV-FS | 2" x 6" |

TYPE BW HOLD-DOWN PLATE (USA ONLY)

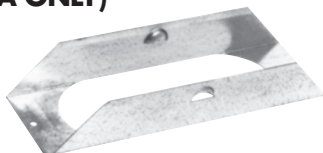

- The Type BW hold-down plate is required for connecting Type BW vent to a wall furnace outlet.

| Size | Product No. | Part No. |
|------|-------------|----------|
| 4" | 164410 | 4OV-BP |

Oval Tops, Supports And Firestops *continued*

- Type BW plate spacers are required at the first ceiling level above a wall furnace to center and space vent properly and to provide the required opening between floors. Firestop spacers must be used at subsequent levels.

| Size | Product No. | Part No. |
|------|-------------|----------|
| 4" | 164520 | 40V-CS |

- The Type BW attic shield is used on a single-story AVS building or on the top story of a multi-story building for Type BW gas vent.
- A 26-gauge galvanized sleeve should extend from the top of the ceiling plate into the attic.
- A Type BW attic shield is required by Los Angeles Code and UMC.

| Size | Product No. | Part No. |
|------|-------------|----------|
| 4" | 164490 | 40V-AS |

- The Type BW installation kit contains one pair of Type BW Plate Spacers (40V-CS) and one BW Hold Down Plate (40V-BP).

| Size | Product No. | Part No. |
|------|-------------|----------|
| 4" | 164607 | 40V-BW |

TYPE BW PLATE SPACERS (USA ONLY)

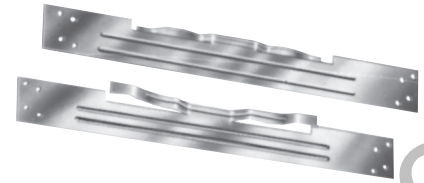

TYPE BW ATTIC SHIELD (USA ONLY)

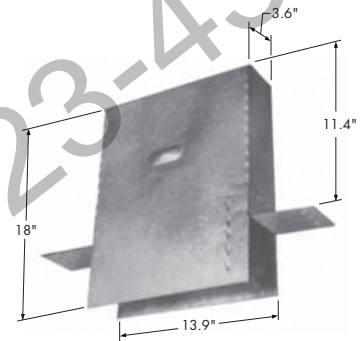

TYPE BW INSTALL KIT

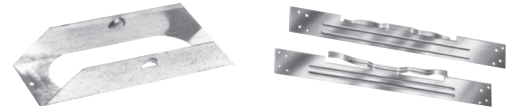

Flashings and Storm Collar

- The flashing is installed either parallel or perpendicular to the roof ridge, and fits roof pitches flat to 5/12.

| Size | Product No. | Part No. |
|------|-------------|----------|
| 4" | 164825 | 40V-AF |
| 5" | 165825 | 50V-AF |
| 6" | 166825 | 60V-AF |

PITCH FLASHING - FLAT TO 5/12 (USA ONLY)

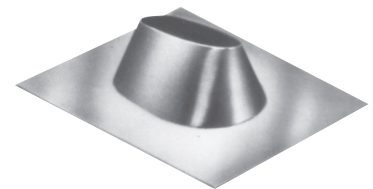

- The storm collar serves as a counter flashing and requires mastic to seal to the vent pipe.

| Size | Product No. | Part No. |
|------|-------------|----------|
| 4" | 164810 | 40V-SC |
| 5" | 165810 | 50V-SC |
| 6" | 166810 | 60V-SC |

OVAL STORM COLLAR (USA ONLY)



Oval Adapters, Connectors and Increases

ROUND TO OVAL ADAPTER (USA ONLY)

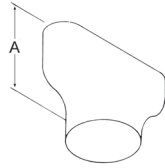

- The round-to-oval adapter is used for conversion of vent from round to oval.

| Size | Product No. | Part No. | A |
|------|-------------|----------|---------|
| 4" | 164370 | 4RV-OV4 | 6-7/8" |
| 5" | 165370 | 5RV-OV5 | 9-3/8" |
| 6" | 166370 | 6RV-OV6 | 10-3/4" |

OVAL TO ROUND ADAPTER

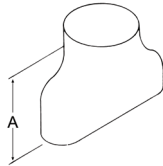

- The oval-to-round adapter is used for conversion of vent from oval to round.

| Size | Product No. | Part No. | A |
|------|-------------|----------|---------|
| 4" | 164380 | 4OV-RV4 | 6-7/8" |
| 5" | 165380 | 5OV-RV5 | 9-3/8" |
| 6" | 166380 | 6OV-RV6 | 10-3/4" |

NOTE: Only 4" is available in Canada

4" OVAL INCREASER TO 5" (USA ONLY)



- The increaser permits increasing of vent from 4" oval to 5" oval

| Size | Product No. | Part No. |
|------|-------------|----------|
| 4" | 164930 | 4OV-5OV |

DWC Double Wall Flexible Gas Vent Pipe

DWC 3" through 5"

Selkirk DWC Double Wall Flexible Gas Vent pipe is available in 3", 4", & 5" diameters in 2', 3', 4', & 5' lengths designed for easy connection to standard Type B Gas Vent. DWC is listed for use as a "segment" of an unenclosed Type B gas vent system and is fully safety certified for use in conditioned and/or unconditioned attics and crawl spaces (US Only). DWC can simplify alignment of most installations by enabling a quick and easy offset between sections of rigid gas vent.

| Size | Product No. | Part No. |
|-----------|-------------|-----------|
| 3" | 1730022 | 3DWC - 2' |
| 3" | 1730033 | 3DWC - 3' |
| 3" | 1730044 | 3DWC - 4' |
| 3" | 1730066 | 3DWC - 5' |
| 3" | 1734300 | 3DWC - SS |
| 4" | | |
| 4" | 1740022 | 4DWC - 2' |
| 4" | 1740033 | 4DWC - 3' |
| 4" | 1740044 | 4DWC - 4' |
| 4" | 1740066 | 4DWC - 5' |
| 4" | 1744300 | 4DWC - SS |
| 5" | | |
| 5" | 1750022 | 5DWC - 2' |
| 5" | 1750033 | 5DWC - 3' |
| 5" | 1750044 | 5DWC - 4' |
| 5" | 1750066 | 5DWC - 5' |
| 5" | 1754300 | 5DWC - SS |

DOUBLE WALL FLEXIBLE B-VENT



NOTE: SS = Support Spacer
Support Spacer not available in Canada

EFC 3" through 4"

The Selkirk Model EFC Expandable Flexible Gas Vent Connector is designed for use with gas-fired appliances equipped with draft hoods and other appliances listed for use with Type B Gas Vent. This Model EFC Expandable Flexible Gas Vent Connector system eliminates the need for elbows and greatly simplifies most gas appliance vent installations. The Model EFC is available in 3" & 4" diameters and can expand from 2 feet to 3 1/2 feet or 2 1/2 feet to 5 feet. Ask your sales associate for details.

| Size | Product No. | Part No. | Description |
|-----------|-------------|----------|-----------------------------|
| 3" | 173036 | 3EFC-3 | 3" (2'-3.5') Flex Connector |
| 3" | 173060 | 3EFC-5 | 3" (2.5'-5') Flex Connector |
| 4" | | | |
| 4" | 174036 | 4EFC-3 | 4" (2'-3.5') Flex Connector |
| 4" | 174061 | 4EFC-5 | 4" (2.5'-5') Flex Connector |

EXPANDABLE FLEXIBLE GAS VENT CONNECTOR



FLEXI BASIC KIT



- Available in 3", 4", 5", 5.5", 6", 7" and 8" diameters
- Available in 15', 25' and 35' lengths
- Listed to: UL1777 and ULC-S635
- Compatible with Type B gas vent systems
- Kit includes length, round top, flashing with 3" collar, mortar guard, fasteners and instructions

AF*-FC Flexi Coupler is available to assist in joining flexible lengths or connecting to fittings.

AF*-BVA Type B Gas Vent Adapter is available to transition from Type B Gas Vent to Flexi Chimney Liner.

| Size | Length | Product No. | Part No. | Pack |
|--------------------|--------|-------------|-----------|------|
| 3" | 15' | 1730015 | AF15-03 | 1 |
| 4" | 15' | 1740015 | AF15-04 | 1 |
| 5" | 15' | 1750015 | AF15-05 | 1 |
| 25' Lengths | | | | |
| 3" | 25' | 1730025 | AF25-03 | 1 |
| 4" | 25' | 1740025 | AF25-04 | 1 |
| 5" | 25' | 1750025 | AF25-05 | 1 |
| 5.5" | 25' | 1755025 | AF25-05.5 | 1 |
| 6" | 25' | 1760025 | AF25-06 | 1 |
| 7" | 25' | 1770025 | AF25-07 | 1 |
| 8" | 25' | 1780025 | AF25-08 | 1 |
| 35' Lengths | | | | |
| 3" | 35' | 1730035 | AF35-03 | 1 |
| 4" | 35' | 1740035 | AF35-04 | 1 |
| 5" | 35' | 1750035 | AF35-05 | 1 |
| 5.5" | 35' | 1755035 | AF35-05.5 | 1 |
| 6" | 35' | 1760035 | AF35-06 | 1 |
| 7" | 35' | 1770035 | AF35-07 | 1 |
| 8" | 35' | 1780035 | AF35-08 | 1 |

Gas Appliance Chimney Liner Systems *continued*

- 10', 25' and 35' flexible liner lengths.
- Includes coupler and fastener package.
- UL-listed.

| Size | Length | Product No. | Part No. | Pack |
|--------------------|--------|-------------|------------|------|
| 3" | 10' | 1730010 | AFE10-03 | 1 |
| 4" | 10' | 1740010 | AFE10-04 | 1 |
| 5" | 10' | 1750010 | AFE10-05 | 1 |
| 5.5" | 10' | 1755010 | AFE10-05.5 | 1 |
| 6" | 10' | 1760010 | AFE10-06 | 1 |
| 7" | 10' | 1770010 | AFE10-07 | 1 |
| 8" | 10' | 1780010 | AFE10-08 | 1 |
| 25' Lengths | | | | |
| 3" | 25' | 1730250 | AF3-25L | 1 |
| 4" | 25' | 1740250 | AF4-25L | 1 |
| 5" | 25' | 1750250 | AF5-25L | 1 |
| 6" | 25' | 1760250 | AF6-25L | 1 |
| 7" | 25' | 1770250 | AF7-25L | 1 |
| 8" | 25' | 1780250 | AF8-25L | 1 |
| 35' Lengths | | | | |
| 3" | 35' | 1730350 | AF3-35L | 1 |
| 4" | 35' | 1740350 | AF4-35L | 1 |
| 5" | 35' | 1750350 | AF5-35L | 1 |
| 6" | 35' | 1760350 | AF6-35L | 1 |
| 7" | 35' | 1770350 | AF7-35L | 1 |
| 8" | 35' | 1780350 | AF8-35L | 1 |

FLEXI EXTENSION KIT



- For fitting or joining Flexi-Liner lengths

| Size | A | B | Product No. | Part No. | Pack |
|------|----|-------|-------------|----------|------|
| 3" | 4" | 2.97" | 173085 | AF3-FC | 1 |
| 4" | 4" | 3.97" | 174085 | AF4-FC | 1 |
| 5" | 4" | 4.97" | 175085 | AF5-FC | 1 |
| 5.5" | 4" | 5.47" | 175585 | AF55-FC | 1 |
| 6" | 4" | 5.97" | 176085 | AF6-FC | 1 |
| 7" | 4" | 6.97" | 177085 | AF7-FC | 1 |
| 8" | 4" | 7.97" | 178085 | AF8-FC | 1 |

FLEX COUPLER

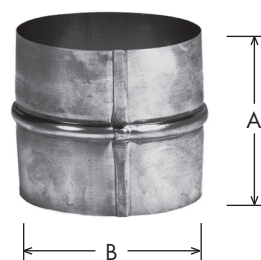

- Used to stretch and lead Flexi-Liner down chimneys

| Size | Product No. | Part No. | Pack |
|------|-------------|----------|------|
| 3" | 173000 | FX3-PD | 6 |
| 4" | 174000 | FX4-PD | 6 |
| 5" | 175000 | FX5-PD | 6 |
| 5.5" | 175500 | FX55-PD | 6 |
| 6" | 176000 | FX6-PD | 6 |
| 7" | 177000 | FX7-PD | 6 |
| 8" | 178000 | FX8-PD | 6 |

PULL DOWN

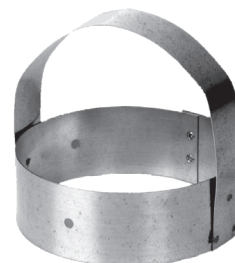

ADAPTERS

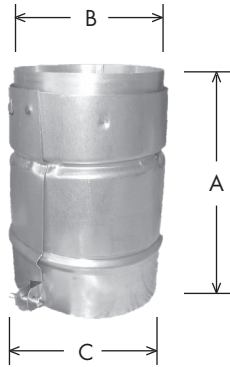

- Adapter to transition from all brands of listed Type B Gas Vent to Flexi-Liner

| Size | A | B | C | Product No. | Part No. | Pack |
|------|-------|-------|-------|-------------|----------|------|
| 3" | 5.88" | 2.95" | 3.57" | 173086 | AF3-BVA | 6 |
| 4" | 5.88" | 3.95" | 4.57" | 174086 | AF4-BVA | 6 |
| 5" | 5.88" | 4.95" | 5.57" | 175086 | AF5-BVA | 6 |
| 6" | 5.88" | 5.95" | 6.57" | 176086 | AF6-BVA | 6 |
| 7" | 5.88" | 6.95" | 7.57" | 177086 | AF7-BVA | 6 |
| 8" | 5.88" | 7.95" | 8.57" | 178086 | AF8-BVA | 6 |

FLEXI INSULATED SLEEVE



- Insulation sleeve with tough poly exterior.
- Cable ties included

| Size | Product No. | Part No. | Pack |
|-----------|-------------|----------|------|
| 3"- 4" | 1740120 | AF4-FS | 5 |
| 5" | 1750120 | AF5-FS | 5 |
| 5.5" - 6" | 1760120 | AF6-FS | 5 |
| 7" | 1770210 | AF7-FS | 5 |
| 8" | 1780210 | AF8-FS | 5 |

Submittal Specifications (USA ONLY)

SUBMITTAL SPECIFICATIONS FOR FACTORY-BUILT TYPE B GAS VENT (USA ONLY)

- TYPE: Factory-built double-wall gas vent
- APPLICATION: For venting negative pressure gas-burning appliances certified for use with Type B Gas Vent as described in NFPA 211, NFPA 54 and/or the International Fuel Gas Code.
- SIZES: 3" diameter through 8" diameter (nominal inside diameter)

| Size (I.D.) | Component | Thickness | Component | Thickness |
|-------------|------------------|-----------|------------|-----------|
| 3"- 8" | Inner Liner | .012" | Outer Wall | .018" |
| 4" | Oval Inner Liner | .012" | Outer Wall | .018" |
| 5"-6" | Oval Inner Liner | .016" | Outer Wall | .018" |

- INSULATION: Airspace between inner and outer pipe.
- UNDERWRITERS LABORATORIES, INC. LISTED: Per UL Standard UL441 (Latest Edition).
- FUEL TYPE: For use with Natural Gas, Propane or L.P. Gas Only

| Inside Dimension | Outside Dimension | Clearance |
|--------------------------------------|-----------------------|-----------|
| 3" through 8" (Round, 1" increments) | Inside Diameter + ½" | 1" |
| 4" Oval (2" x 6 ¾") * | Inside Dimension + ½" | 1" ** |
| 5" Oval (2" x 10 ¼") * | Inside Dimension + ½" | 1" ** |
| 6" Oval (2 13/16" x 11 1/8") * | Inside Dimension + ½" | 1" ** |

* Given measurements are the major oval dimensions. 4" & 5" Oval vent can be installed within 2"x 4" stud walls; 5" & 6" Oval can be installed within 2"x 6" stud walls.

** Proper clearance in a stud wall is the distance created by centering the vent within the stud wall and will be less than one inch. The size referenced for oval vent corresponds to the diameter of a round vent of equivalent area. See full catalog for component dimensions.

Material

Inner Liner of Aluminum Alloy 1100, 3003, 3104, 3105 or 5010
Outer Wall of UL Recognized G90 Galvanized Steel

Job Name: _____
 Location: _____
 Architect: _____
 Engineer: _____
 Contractor: _____

Submitted By: _____ Date: _____
Selkirk Corporation Type B Gas Vent Specification
 Model RV: 3" – 8" diameter round vent
 Model OV: 4" – 6" equivalent diameter oval vent

Selkirk Corporation
 5030 Corporate Exchange Blvd.
 Grand Rapids, MI 49512
 Toll Free: 1.800.433.6341

Customer Service and Support:

| | |
|-------------------------------------|--------------|
| Airmate (USA)..... | 800.992.8368 |
| Airmate (CAN)..... | 888.735.5475 |
| Ameriflow..... | 800.252.8467 |
| Amerivent (Retail)..... | 800.252.8467 |
| Amerivent (Hearth & Wholesale) | 800.423.4270 |
| Amerivent (Support)..... | 800.748.0392 |
| AMPCO (USA)..... | 800.669.3269 |
| AMPCO (CAN)..... | 888.735.5475 |
| Duravent..... | 800.835.4429 |
| Hart & Cooley..... | 800.433.6341 |
| Hart & Cooley (Support)..... | 800.748.0392 |
| Heatfab (USA)..... | 800.772.0739 |
| Heatfab (CAN)..... | 800.848.2149 |
| Lima..... | 800.423.4270 |
| Milcor..... | 800.774.5240 |
| Portals Plus..... | 800.774.5240 |
| RPS..... | 800.624.8642 |
| Security Chimney (USA)..... | 800.361.4909 |
| Security Chimney (CAN)..... | 800.667.3387 |
| Selkirk (USA) Residential..... | 800.992.8368 |
| Selkirk (USA) Commercial..... | 800.848.2149 |
| Selkirk (USA) Support..... | 800.748.0392 |
| Selkirk (CAN)..... | 888.735.5475 |

Manufacturing & Distribution Centers:

| | |
|------------------|------------------------------|
| CANADA | |
| Nobel, ON | Manufacturing |
| Laval, QC | Manufacturing |
| Prescott, ON | Distribution |
| USA | |
| Grand Rapids, MI | Center of Excellence |
| Dallas, TX | Distribution |
| Englewood, OH | Distribution |
| Huntsville, AL | Manufacturing & Distribution |
| Mira Loma, CA | Distribution |
| Nampa, ID | Manufacturing & Distribution |
| Turner Falls, MA | Manufacturing & Distribution |
| Vacaville, CA | Manufacturing |
| MEXICO | |
| Ojinaga, MX | Manufacturing |
| Mexicali, MX | Manufacturing |

Corporate Headquarters:

Duravent Group
 28 W. Adams, Suite 1810
 Detroit, MI 48226
 Tel: 800.835.4429
 Email: info@duraventgroup.com
www.duraventgroup.com



CozyCabin.com 518-623-4349

duravent[™]
GROUP

BUILD FOR THE FUTURE

www.duraventgroup.com

