

MI-ALK Metal Insert Ambient Light Kit

Models: SUPREME-I30-IFT, SUPREME-I30-BIR, SUPRM-I30LP-IFT, SUPREME-I35-IFT, SUPREME-I35-BIR, EXCURSION-II, EXCURSION-III, RUBY30I / 35I, TRILLIANT30I / 35I

Installation Instructions

LIGHTS NOT RECOMMENDED WITH MAGIC GLASS



Leave this instruction with party responsible for use and operation.



DANGER



HOT GLASS WILL CAUSE BURNS.

DO NOT TOUCH GLASS UNTIL COOLED.

NEVER ALLOW CHILDREN TO TOUCH GLASS.

A barrier designed to reduce the risk of burns from the hot viewing glass is provided with this appliance and must be installed for the protection of children and other at-risk individuals.

CAUTION! Risk of Burns! The fireplace should be turned off and cooled before servicing.

CAUTION! Risk of Cuts or Abrasions. Wear protective gloves and safety glasses during installation. Sheet metal edges are sharp.

CAUTION! Do not install damaged components. If you received components that are damaged, contact your dealer for assistance.

Tools and Supplies Needed:

- Screw Gun
- 1/4 in. Hex Driver Bit
- 3/8" Wrench
- Multi-purpose tool (appliance manual bag)
- Gloves

KIT CONTENTS:

- Light Assembly
- 50 Watt Ember Bulb (2)
- Accent Glass (2)
- Light Glass Hold Down (2)
- Valve Tub Gasket
- Light Glass Gasket (4)
- 10-32 Nut (8)
- Ember Rocks (Not Shown)

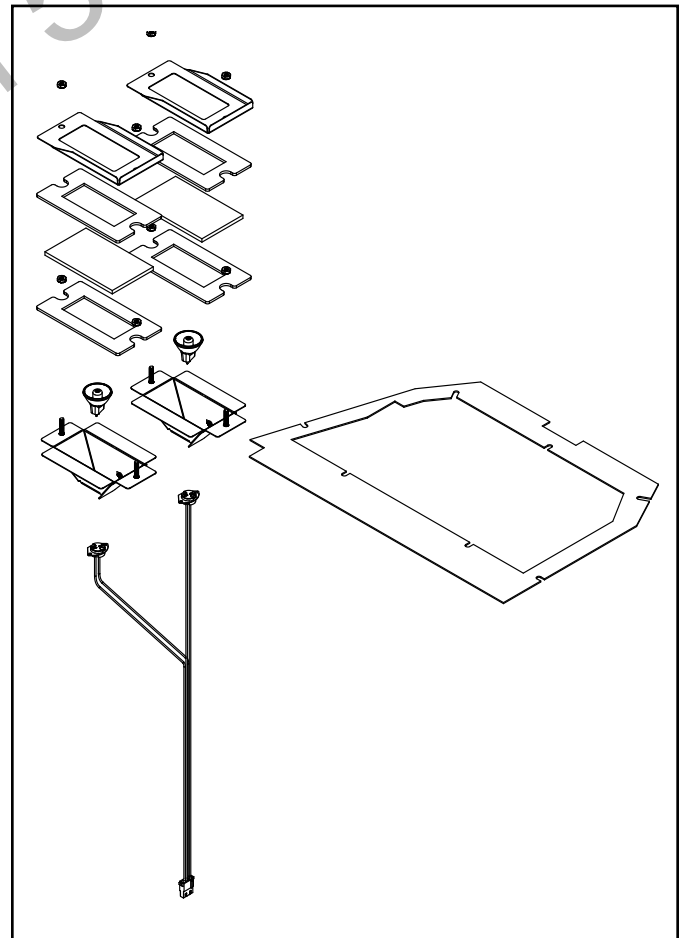

Figure 1. Kit Contents

PREPARATION

1. Shut off gas supply and disconnect electrical power.
2. Remove decorative front, glass assembly, glass seal plate, mystic embers, embers and logs if previously installed.
3. Remove the screws that attach the base pan to the burner and lift the base pan out of the appliance.
4. Remove the burner bracket screw. Slide burner to the left and lift out of the appliance. Be careful not to damage the pilot sense rod.
5. Remove the screws from the valve tub. The pilot wires, pilot gas tube, and flex orifice line will still be attached to the valve tub. Set the valve tub to the side in order to allow access to the underside of the firebox. See Figure 2 and 3. Remove and discard old valve tub gasket.



Figure 2

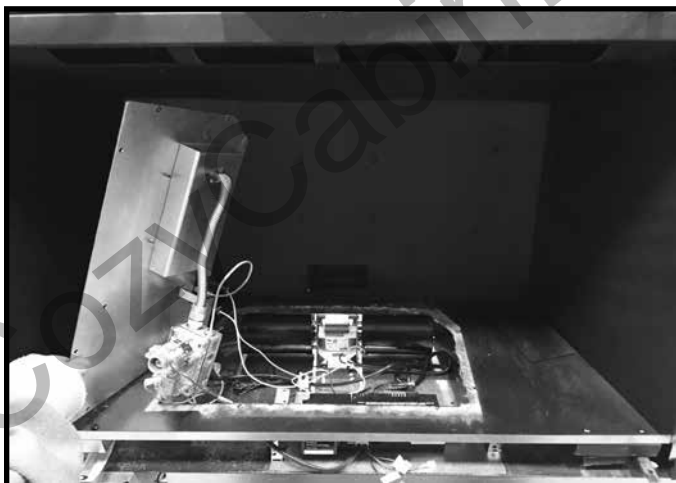

Figure 3

6. Remove the 6-pin wire harness and the regulator wire harness from the wire hold down tabs on the component tray. Slide the locking tab over and slide the component tray forward for easier access. See Figure 4.

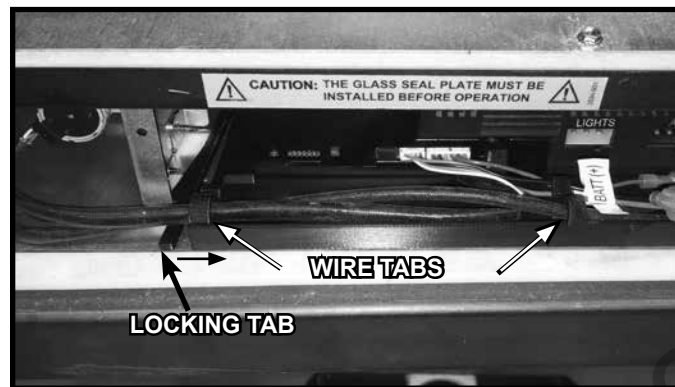

Figure 4

7. Using a 3/8 in. wrench, loosen and remove the nuts attaching the cover plates, four (4) total. Remove cover plates and old gaskets.

INSTALLATION

1. Layout MI-ALK parts so they are readily accessible.
2. Place a gasket over each light tub and then install them from under side of the firebox bottom. Make sure the light shield is toward the front of the firebox. Once threaded studs are inserted through the firebox bottom, use one 10-32 nut on each threaded stud to hold the light tubs in place. See Figure 5, 6 and 7.

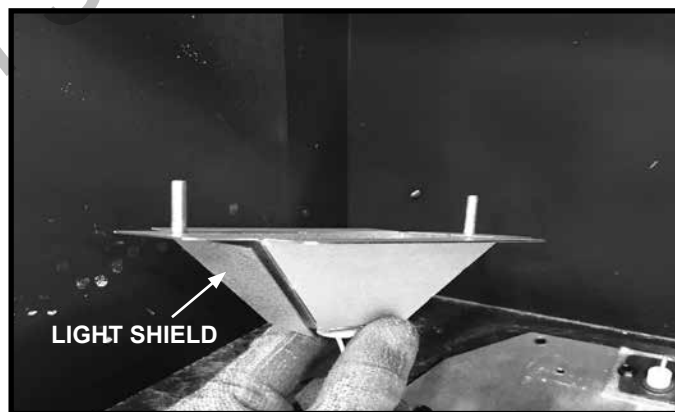

Figure 5



Figure 6

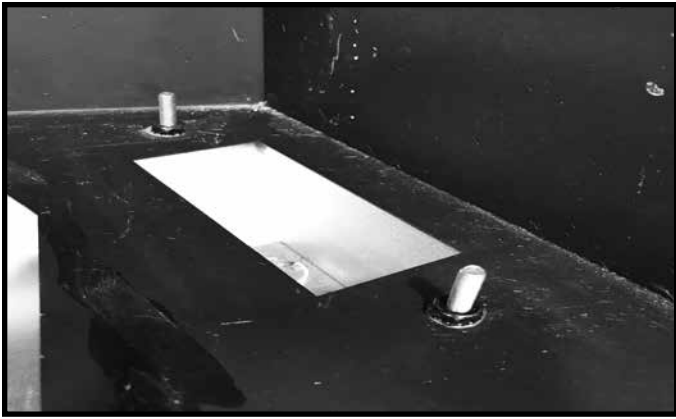

Figure 7

3. Install 50 watt bulbs into the light sockets. Be sure not to touch the bulb with bare skin. Latex or rubber gloves are recommended.
4. Place one light glass gasket over each light tub using the threaded studs as a guide. See Figure 8.

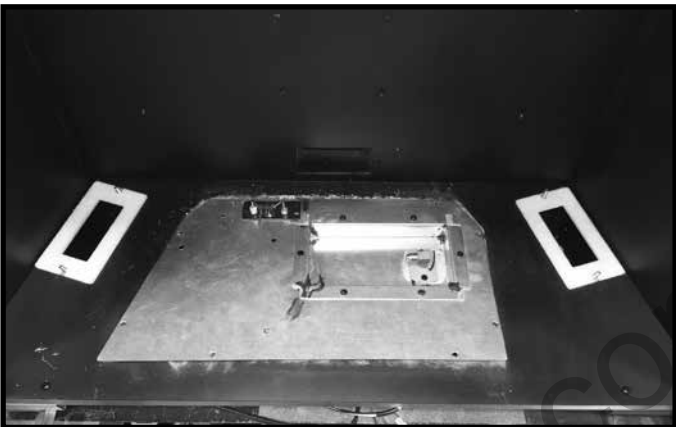

Figure 8

5. Center accent glass on each gasket. See Figure 9.

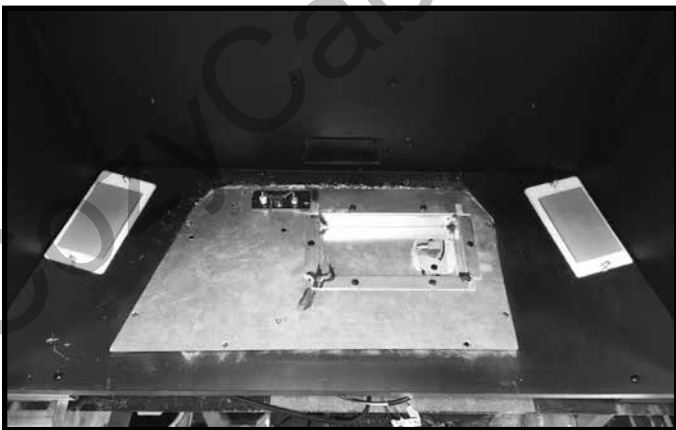

Figure 9

6. Place one light glass hold down over each piece of accent glass with the ember rock lip towards the front of the appliance. See Figure 9.

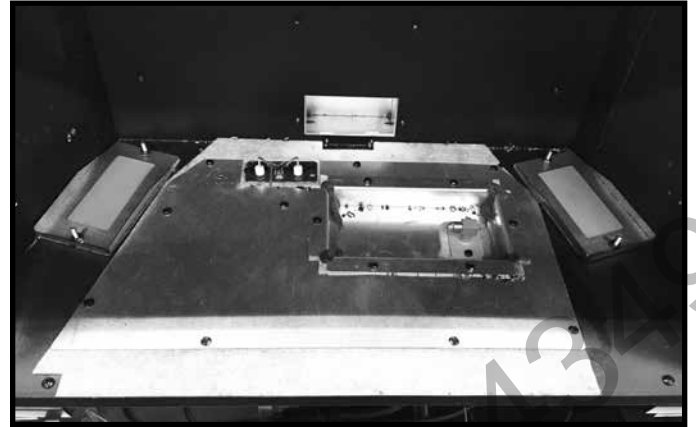

Figure 10

7. Use 10-32 nuts to secure light glass hold down in place.
8. Route the light wires through the wire clip and around the end of the component heat shield as shown in Figure 11 and plug into the Auxiliary Control Module. See wiring diagram for reference (Figure 14).

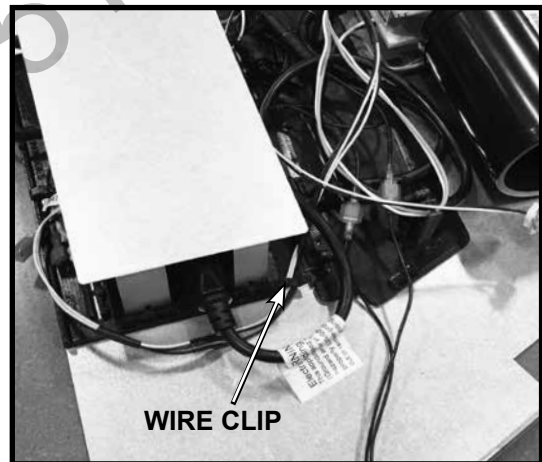

Figure 11

9. Place new valve tub gasket around the valve tub cutout and locate on screw locations.
10. Verify the location of the valve tub gasket is correct and re-attach the valve tub.
11. Install the burner assembly, one (1) screw.
12. Install the base pan assembly, five (5) screws.
13. Refer to the RC-400 remote control instructions to re-program the module and remote for use with lights. This will activate the light controls on the RC-400 touch screen.
14. Slide the component tray back into place.

15. Install ember rocks by placing directly on the accent glass. Cover until the ember rocks are approximately level with the basepan. Each side will use less than half of the bag of ember rocks. See Figures 12 & 13.
16. Re-install glass seal plate, logs, embers, mystic embers, glass assembly and decorative front.



Figure 12

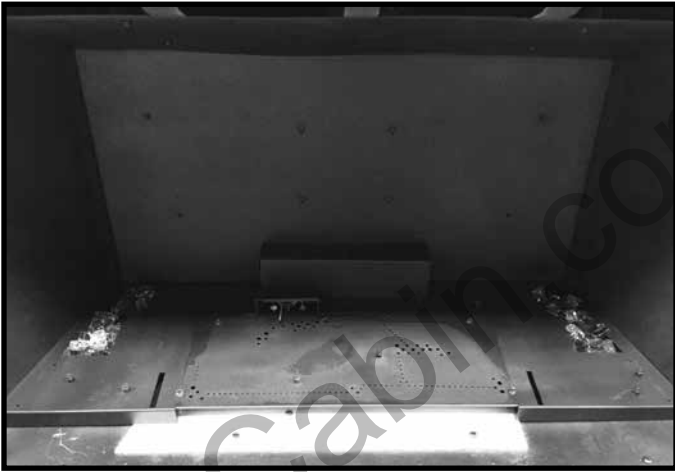

Figure 13

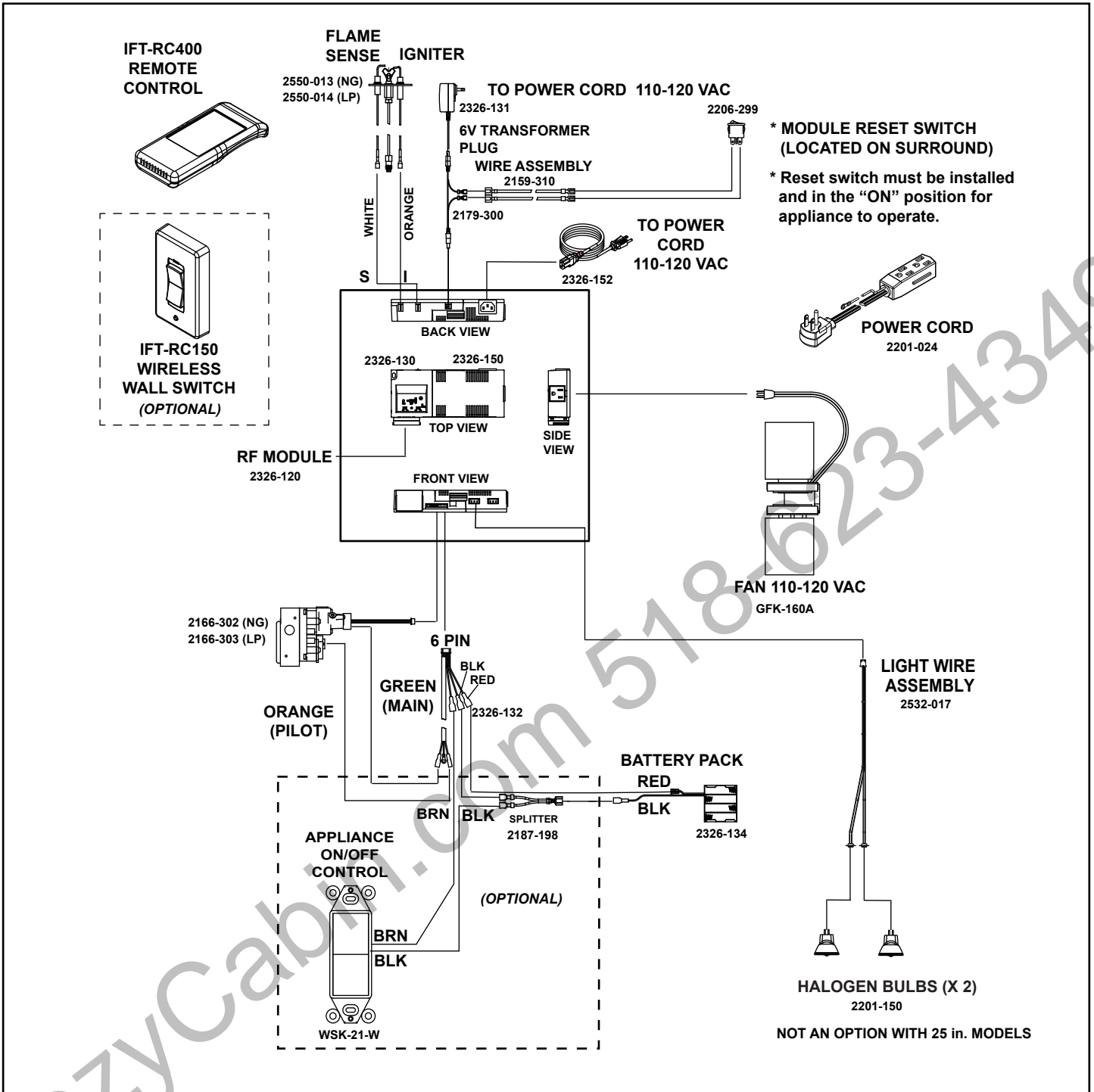

Figure 13 Intellifire Touch® Wiring Diagram

Light Operation

The lights are operated using the Lights function on the remote control. See Figure 14.

Using the RC400 remote control:

1. Select the MAIN MENU
2. Select LIGHTS
3. Select the desired light level

Service Parts

PART NUMBER	DESCRIPTION
2201-150	50W Bulb
2532-017	Light Wire Assembly
2532-149	Light Glass Hold Down
2532-150	Light Glass Gasket
2532-151	Accent Glass
2532-131	Valve Tub Gasket
2201-853	Ember Rocks

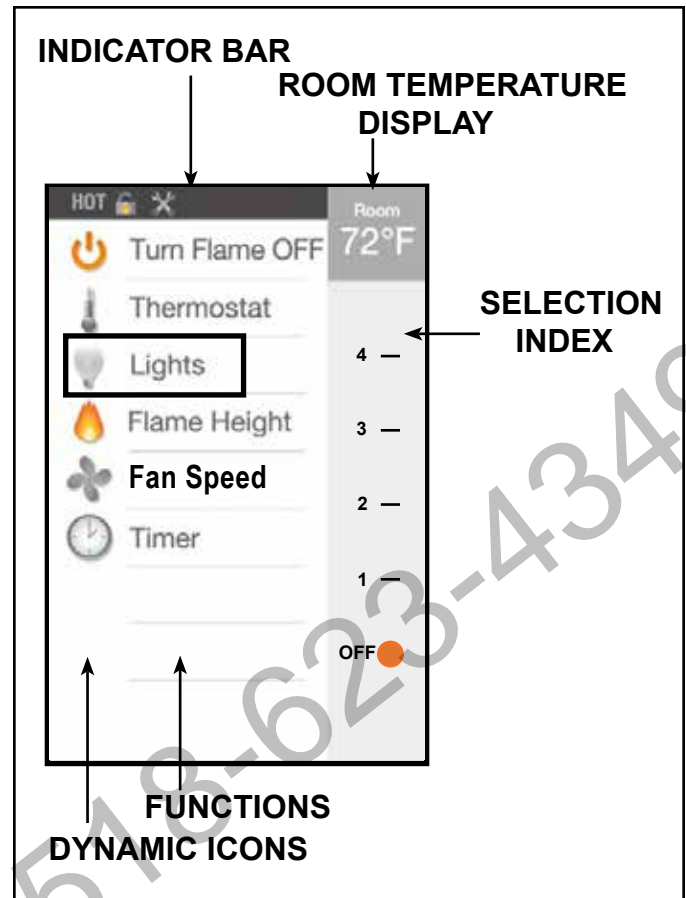

Figure 14. RC400 Display Screen

Please contact your Hearth & Home Technologies dealer with any questions or concerns.
For the location of your nearest Hearth & Home Technologies dealer, please visit www.hearthnhome.com

Hearth & Home Technologies
7571 215th Street West, Lakeville, MN 55044
www.hearthnhome.com